

**\$10,000
ANYTHING
ALLOWANCE!**

209
\$268,800

211
\$274,800

213
\$274,800

215
\$249,800



\$274,800.00

213 E COUNTRYSIDE AVE

<https://harr-lemme.com>

Lot 5 BLOCK 11 COUNTRYSIDE STATES ADDITION

- 3 beds
- 3 baths
- Town Home, Two Story
- New Construction, RESIDENTIAL
- Active-New
- 1531 sq ft

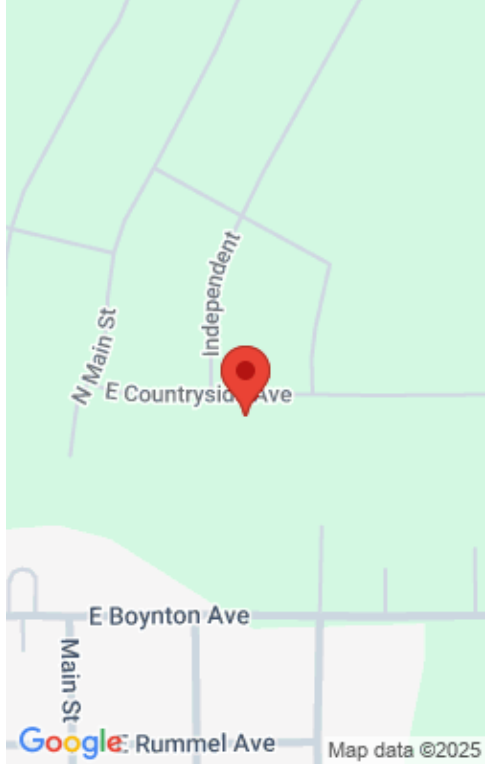

Basics

Category: New Construction, RESIDENTIAL
Status: Active-New
Bathrooms: 3 baths
Floor level: 692
Lot size: 3925 sq ft

Type: Town Home, Two Story
Bedrooms: 3 beds
Total rooms: 8
Area: 1531 sq ft
Year built: 2024

Schools

School District: Lennox
Middle: Lennox MS

Elementary: Lennox ES
High School: Lennox HS

Agent

AgentEmail: amy@nielsonconstruction.net
AgentMI: L
AgentPhoneNumber: 605-400-3784

AgentFirstName: Amy
AgentLastName: Evans

Building Details

Floor covering: Carpet, Vinyl
Exterior material: Hard Board, Stone/Stone Veneer

Basement: None
Parking: Attached

Amenities & Features

Amenities: Garbage, Lawn Care, Snow Removal

Features: 3+ Bedrooms Same Level, Master Bath



Realty Office

Office Name: House 2 Home LLC

Office State: SD

Office Email: sales@house2homesd.com

Office City: Harrisburg

Office Phone: 605-973-9595

Office Website: www.house2homesd.com

