



**\$310,300.00**

## **2416 E CAMA PL**

<https://harr-lemme.com>

**LOT 10 BLOCK 3 DONAHOE FARMS ADD CITY OF SIOUX FALLS**

- 3 beds
- 3 baths
- 1.5 Story, Town Home
- New Construction, RESIDENTIAL
- Active, Active-New
- 1657 sq ft

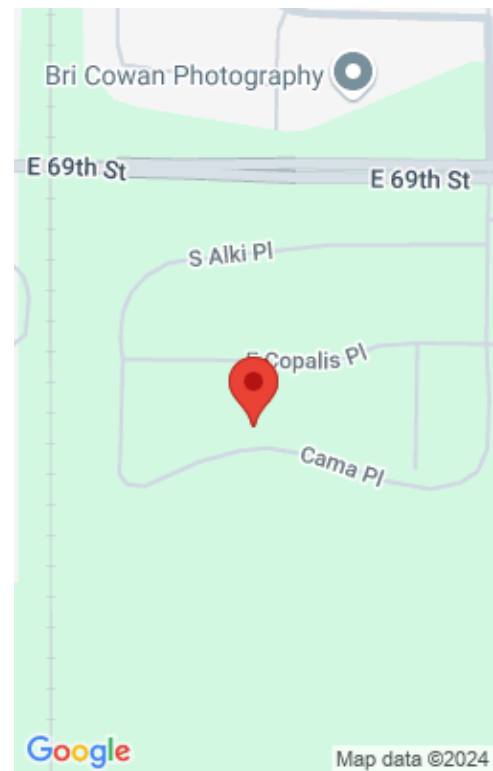

---

## Basics

**Category:** New Construction, RESIDENTIAL

**Status:** Active, Active-New

**Bathrooms:** 3 baths

**Floor level:** 962

**Lot size:** 0 sq ft

**Type:** 1.5 Story, Town Home

**Bedrooms:** 3 beds

**Total rooms:** 11

**Area:** 1657 sq ft

**Year built:** 2024

---

## Schools

**School District:** Harrisburg

**Middle:** Harrisburg East Middle School

**Elementary:** Horizon Elementary

**High School:** Harrisburg HS

---

## Agent

**AgentEmail:** sales@empirecompanies.com

**AgentLastName:** Hyde

**AgentFirstName:** Brady

**AgentPhoneNumber:** 605-553-0163

---

## Building Details

**Floor covering:** Carpet, Laminate, Vinyl

**Exterior material:** Cement Hardboard, Part Brick

**Parking:** Attached

**Basement:** None

**Roof:** Shingle Composition

---

## Amenities & Features

**Amenities:** Garbage, Lawn Care, Road Maint, Snow Removal

**Features:** 3+ Bedrooms Same Level, Master Bath



---

# Realty Office

**Office Name:** Keller Williams Realty Sioux Falls

**Office State:** SD

**Office Email:** [klrw923@kw.com](mailto:klrw923@kw.com)

**Office City:** Sioux Falls

**Office Phone:** 605-275-0555

**Office Website:** [siouxfalls.yourkwoffice.com/](http://siouxfalls.yourkwoffice.com/)

