



**\$424,800.00**

## **201 N EVEREST AVE**

<https://harr-lemme.com>

**LOT 11, BLOCK 4, PINNACLE ADDITION**

- 2 beds
- 2 baths
- Ranch, Single Family
- New Construction, RESIDENTIAL
- Active, Active-New
- 1136 sq ft

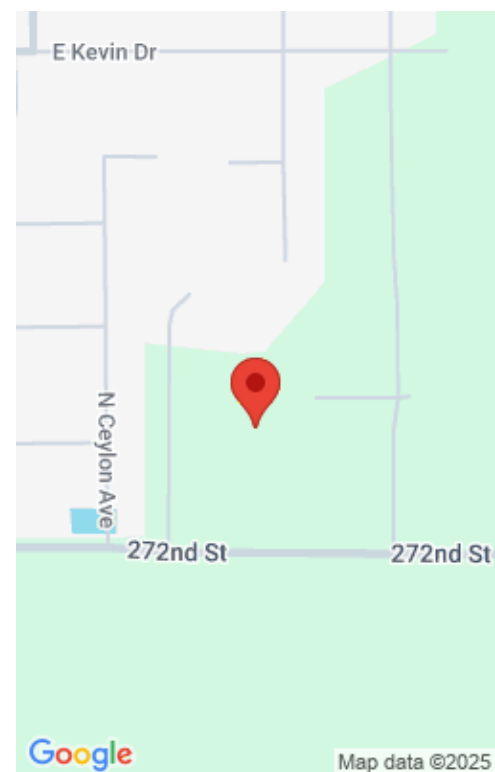

---

## Basics

**Category:** New Construction, RESIDENTIAL

**Status:** Active, Active-New

**Bathrooms:** 2 baths

**Floor level:** 1136

**Lot size:** 15330 sq ft

**Type:** Ranch, Single Family

**Bedrooms:** 2 beds

**Total rooms:** 6

**Area:** 1136 sq ft

**Year built:** 2024

---

## Schools

**School District:** Tea Area

**Elementary:** Tea Area Venture Elementary

**Middle:** Tea MS

**High School:** Tea HS

---

## Agent

**AgentEmail:** amy@nielsonconstruction.net

**AgentFirstName:** Amy

**AgentMI:** L

**AgentLastName:** Evans

**AgentPhoneNumber:** 605-400-3784

---

## Building Details

**Floor covering:** Carpet, Vinyl

**Basement:** Full

**Exterior material:** Hard Board, Stone/Stone Veneer, Wood

**Roof:** Shingle Composition

**Parking:** Detached

---

## Amenities & Features

**Features:** Main Floor Laundry, Master Bath, Master Bed Main Level, Pantry, Tray Ceiling, Vaulted Ceiling



---

# Realty Office

**Office Name:** House 2 Home LLC

**Office State:** SD

**Office Email:** sales@house2homesd.com

**Office City:** Harrisburg

**Office Phone:** 605-973-9595

**Office Website:** www.house2homesd.com

