



1125 E. Thompson Pl. OPEN HOUSE

\$694,900

1125 E THOMPSON PL

<https://harr-lemme.com>

LOT 8B BLOCK 12 NINE MILE LAKE ADDITION IN TEA

- 4 beds
- 3 baths
- Twin Home, Two Story
- Lake, New Construction, RESIDENTIAL
- Active-New
- 2312 sq ft

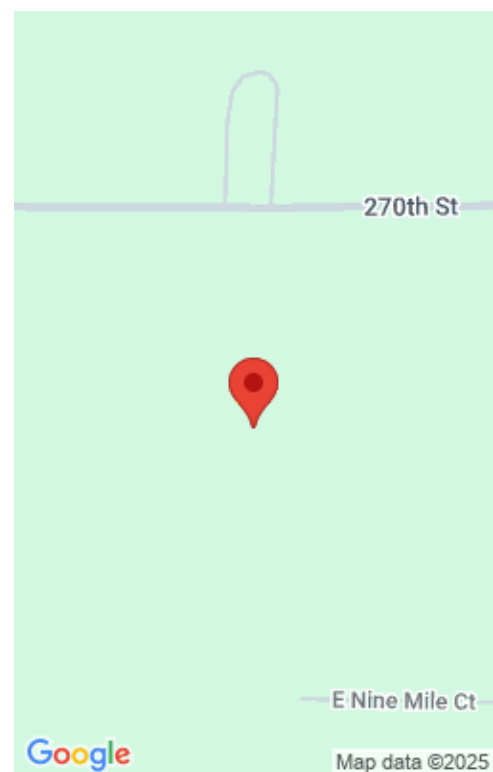

Basics

Category: Lake, New Construction, RESIDENTIAL
Status: Active-New
Bathrooms: 3 baths
Floor level: 1246
Lot size: 7974 sq ft

Type: Twin Home, Two Story
Bedrooms: 4 beds
Total rooms: 10
Area: 2312 sq ft
Year built: 2024

Schools

School District: Tea Area
Elementary: Legacy Elementary School - Tea
Middle: Tea MS
High School: Tea HS

Agent

AgentEmail: Amy@AmyStockberger.com
AgentMI: M
AgentPhoneNumber: 605-731-9597

AgentFirstName: Amy
AgentLastName: Stockberger

Building Details

Floor covering: Carpet, Heated, Tile, Wood
Exterior material: Cement Hardboard, Stone/Stone Veneer
Parking: Attached

Basement: None
Roof: Shingle Composition

Amenities & Features



Amenities: Garbage, Lawn Care,
Other, Road Maint, Snow Removal

Features: 3+ Bedrooms Same Level, Master Bath, Pre-
Wired High Speed, Pre-Wired Surround Sound, Step
Ceiling, Tray Ceiling

Realty Office

Office Name: Amy Stockberger Real Estate

Office State: SD

Office Email: adam@asteaminc.com

Office City: Sioux Falls

Office Phone: 605-376-6780

Office Website: amystockberger.com

