

OPEN HOUSE

Tuesdays | 4:00 PM - 6:00 PM
Wednesdays | 11:00 AM - 3:00 PM
Thursdays | 4:00 PM - 6:00 PM
Fridays | 11:00 AM - 3:00 PM
Saturdays | 1:00 PM - 3:00 PM
Sundays | 1:00 PM - 3:00 PM



\$724,900.00

1207 E THOMPSON PL

<https://harr-lemme.com>

LOT 6A - BLK 12 - NINEMILE LAKE ADD - TEA

- 3 beds
- 2 baths
- Ranch, Twin Home
- Lake, New Construction, RESIDENTIAL
- Active, Active-New
- 2316 sq ft

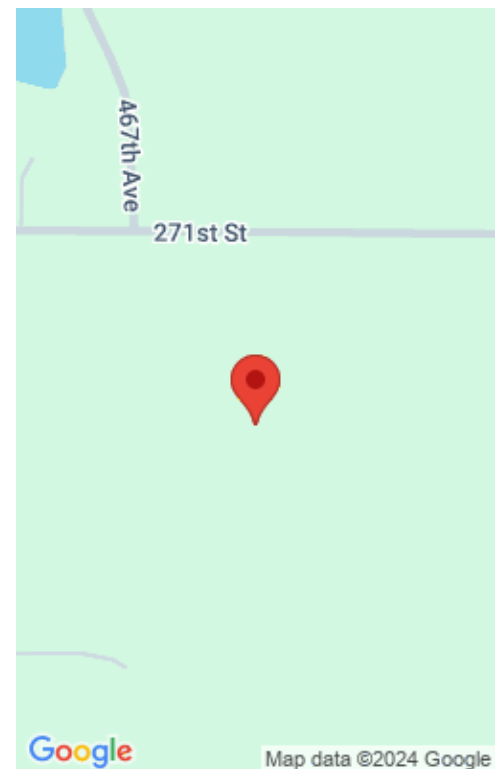

Basics

Category: Lake, New Construction, RESIDENTIAL

Status: Active, Active-New

Bathrooms: 2 baths

Floor level: 2316

Lot size: 7974 sq ft

Type: Ranch, Twin Home

Bedrooms: 3 beds

Total rooms: 11

Area: 2316 sq ft

Year built: 2024

Schools

School District: Tea Area

Middle: Tea MS

Elementary: Legacy Elementary School - Tea

High School: Tea HS

Agent

AgentEmail: Amy@AmyStockberger.com

AgentMI: M

AgentPhoneNumber: 605-731-9597

AgentFirstName: Amy

AgentLastName: Stockberger

Building Details

Floor covering: Carpet, Heated, Tile, Wood

Exterior material: Cement Hardboard, Stone/Stone Veneer

Parking: Attached

Basement: None

Roof: Shingle Composition

Amenities & Features



Amenities: Garbage, Lawn Care, Other, Road Maint, Snow Removal

Features: 3+ Bedrooms Same Level, Main Floor Laundry, Master Bath, Master Bed Main Level, Pre-Wired High Speed, Pre-Wired Surround Sound, Step Ceiling, Tray Ceiling

Realty Office

Office Name: Amy Stockberger Real Estate

Office State: SD

Office Email: adam@asteaminc.com

Office City: Sioux Falls

Office Phone: 605-376-6780

Office Website: amystockberger.com

