

# OPEN HOUSE

Tuesdays | 4:00 PM - 6:00 PM  
Wednesdays | 11:00 AM - 3:00 PM  
Thursdays | 4:00 PM - 6:00 PM  
Fridays | 11:00 AM - 3:00 PM  
Saturdays | 1:00 PM - 3:00 PM  
Sundays | 1:00 PM - 3:00 PM



**\$724,900.00**

## 1205 E THOMPSON PL

<https://harr-lemme.com>

LOT 6B - BLK 12 - NINEMILE LAKE ADD - TEA

- 3 beds
- 2 baths
- Ranch, Twin Home
- Lake, New Construction, RESIDENTIAL
- Active, Active - Contingent Misc, Active-New
- 2316 sq ft

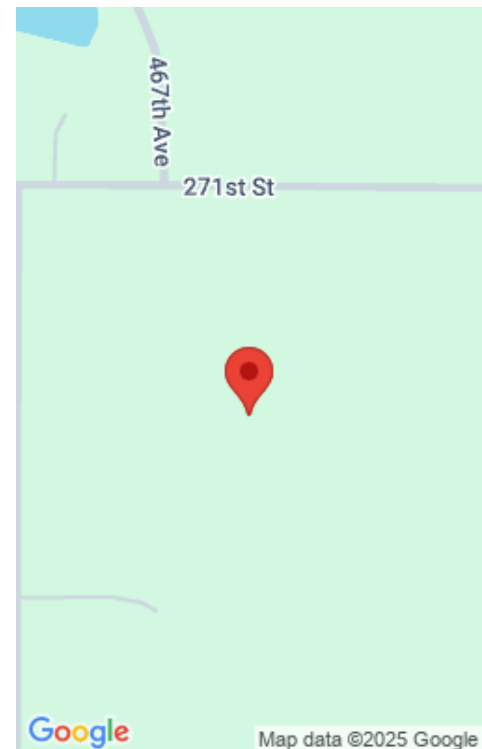

---

## Basics

**Category:** Lake, New Construction, RESIDENTIAL

**Status:** Active, Active - Contingent Misc, Active-New

**Bathrooms:** 2 baths

**Floor level:** 2316

**Lot size:** 7974 sq ft

**Type:** Ranch, Twin Home

**Bedrooms:** 3 beds

**Total rooms:** 11

**Area:** 2316 sq ft

**Year built:** 2024

---

## Schools

**School District:** Tea Area

**Middle:** Tea MS

**Elementary:** Legacy Elementary School - Tea

**High School:** Tea HS

---

## Agent

**AgentEmail:** Amy@AmyStockberger.com

**AgentMI:** M

**AgentPhoneNumber:** 605-731-9597

**AgentFirstName:** Amy

**AgentLastName:** Stockberger

---

## Building Details

**Floor covering:** Carpet, Heated, Tile, Wood

**Exterior material:** Cement Hardboard, Stone/Stone Veneer

**Parking:** Attached

**Basement:** None

**Roof:** Shingle Composition

---

## Amenities & Features



**Amenities:** Garbage, Lawn Care, Other, Road Maint, Snow Removal

**Features:** 3+ Bedrooms Same Level, Main Floor Laundry, Master Bath, Master Bed Main Level, Pre-Wired High Speed, Pre-Wired Surround Sound, Step Ceiling, Tray Ceiling

---

## Realty Office

**Office Name:** Amy Stockberger Real Estate

**Office State:** SD

**Office Email:** adam@asteaminc.com

**Office City:** Sioux Falls

**Office Phone:** 605-376-6780

**Office Website:** amystockberger.com

