

Similar To

E

UNDEFINED UNDEFINED

<https://harr-lemme.com>

Lot 42, Block 1 of Willows Edge addition to Sioux Falls, Minnehaha County, SD



Rhonda Rentz

\$454,425

- 3 beds
- 2 baths
- Ranch, Single Family
- New Construction, RESIDENTIAL
- Active
- 1386 sq ft

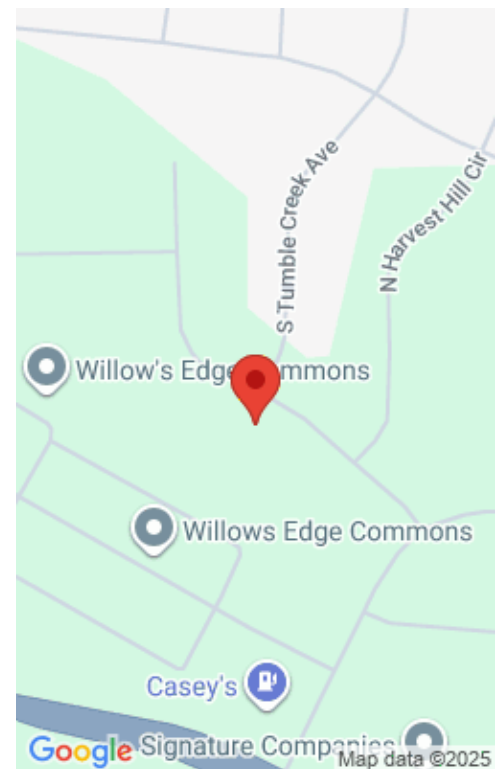

Basics

Category: New Construction, RESIDENTIAL
Status: Active
Bathrooms: 2 baths
Floor level: 1386
Lot size: 7986 sq ft

Type: Ranch, Single Family
Bedrooms: 3 beds
Total rooms: 7
Area: 1386 sq ft
Year built: 2024

Schools

School District: Brandon Valley 49-2
Middle: Brandon Valley MS

Elementary: Fred Assam ES
High School: Brandon Valley HS

Agent

AgentEmail: rhonda@signaturecompaniesllc.com
AgentMI: L
AgentPhoneNumber: 605-310-9490

AgentFirstName: Rhonda
AgentLastName: Rentz

Building Details

Floor covering: Carpet, Luxury Vinyl Plank
Exterior material: Cement Hardboard, Stone/Stone Veneer
Parking: Attached

Basement: Full
Roof: Shingle Composition

Amenities & Features

Amenities: Garbage **Features:** 3+ Bedrooms Same Level, Main Floor Laundry, Master Bath, Master Bed Main Level, Pantry, Tray Ceiling



Realty Office

Office Name: Signature Real Estate & Development Services L.L.C.

Office State: SD

Office Email: info@signaturecompaniesllc.com

Office City: Sioux Falls

Office Phone: 605-275-5888

Office Website:
www.signaturecompaniesllc.com

