



\$2,370,000.00

TBD 281ST ST

<https://harr-lemme.com>

TRACT 2 OF JEROME FIVE'S ADDITION IN THE N1/2 16-98-53 OSR=
.700

- Farm Land
- Building Eligibility, LOTS & LAND, Outside City Limits
- Active-New

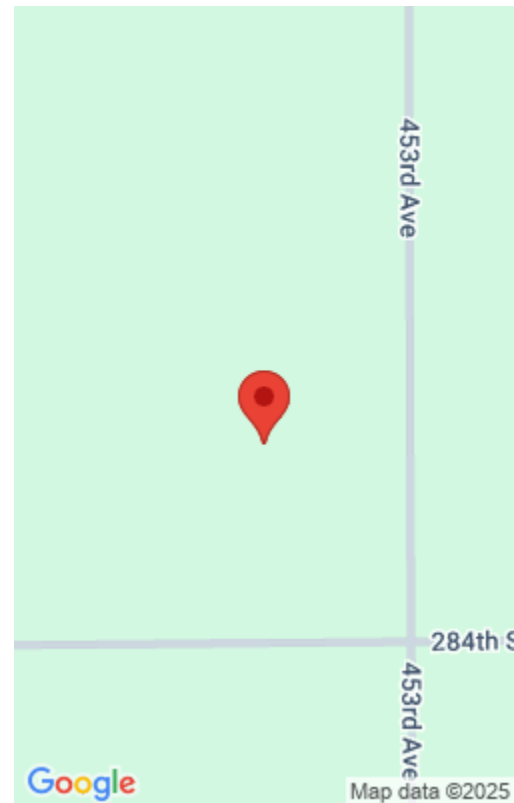

Basics

Category: Building Eligibility, LOTS & LAND, Outside City Limits

Status: Active-New

Type: Farm Land

Lot size: 6886836 sq ft

Agent

AgentEmail: brooke-brown@kw.com

AgentMI: M

AgentPhoneNumber: 605-743-4344

AgentFirstName: Brooke

AgentLastName: Brown

