



\$369,900

9702 BROEK DR

<https://harr-lemme.com>

- 4 beds
- 3 baths
- Residential
- None, Townhouse
- Active - Active
- 2074 sq ft

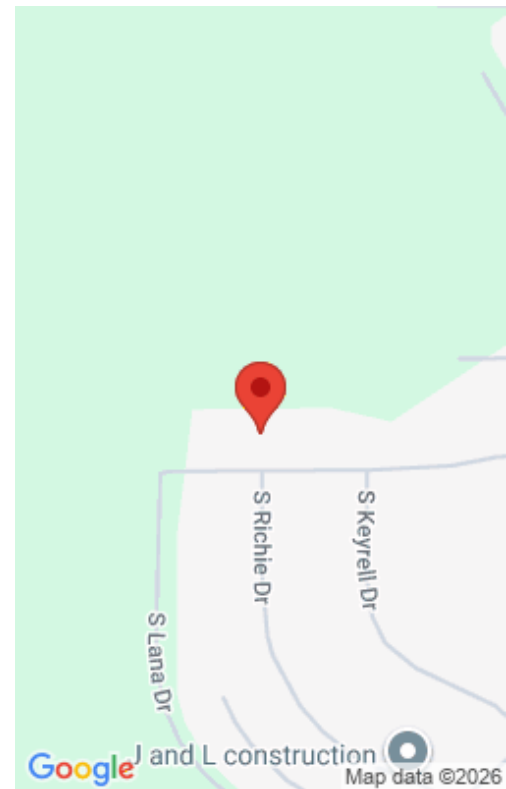

Basics

Status: Active - Active

Category: None, Townhouse

Date added: Added 5 days ago

Bathrooms: 3 baths

Total rooms: 12

Year built: 2021

Type: Residential

Sale Or Rent: S

Bedrooms: 4 beds

Half baths: 0 half baths

Area, sq ft: 2074 sq ft

MLS ID: 22604995

Schools

School District: Tea Area

Middle: Tea MS

High School District: TeaArea

Elementary: Frontier Elementary School - Tea

High School: Tea HS

Middle Or Junior School District: TeaArea

Agent

AgentEmail: Kory@TheExperience.com

AgentMI: N

AgentFirstName: Kory

AgentLastName: Davis

Building Details

Parking Features: , Concrete **Architectural Style:** Ranch

Parking: 2

Foundation Details: Poured

Water Source: Public

Floor covering: Carpet, Vinyl

Roof: Composition

Lot Features: Walk-Out

Construction Materials: Hard Board, Stone

Heating: Natural Gas, 90% Efficient

Parcel Number: 96559

Basement: Full

Sewer: Public Sewer

Subdivision Name: WESTWOOD VALLEY 2ND ADDITION TO THE CITY OF SIOUX FALLS



Amenities & Features

Cooling: Central Air

Fireplace Features: Electric

Fireplaces Total: 1

Patio And Porch Features: , Deck, Patio

