



\$630,000

8609 SHORELINE PL

<https://harr-lemme.com>

- 3 beds
- 2 baths
- Residential
- New Construction, Townhouse
- Active - Active
- 2170 sq ft

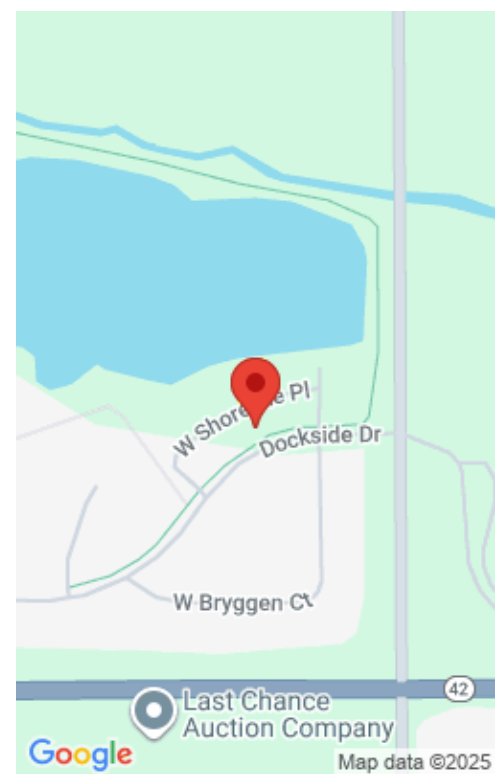

Basics

Status: Active - Active

Category: New Construction, Townhouse

Date added: Added 2 months ago

Bathrooms: 2 baths

Total rooms: 6

Year built: 2022

Days On Market: 20

Type: Residential

Sale Or Rent: S

Bedrooms: 3 beds

Half baths: 1 half bath

Area, sq ft: 2170 sq ft

MLS ID: 22507767

Schools

School District: Sioux Falls

Middle: West Central MS

High School District: Sioux Falls

Elementary: West Central ES

High School: West Central HS

Middle Or Junior School District: Sioux Falls

Agent

AgentEmail: gdoohen@kw.com

AgentMI: T

AgentFirstName: Greg

AgentLastName: Doohen

Building Details

Architectural Style: Two Story

Association Fee: 158.33

Heating: Natural Gas

Parcel Number: 93938

Roof: Composition

Subdivision Name: Cherry Lake Reserve

Parking: 2

Construction Materials: Brick, Hard Board

Water Source: Public

Basement: None

Sewer: Public Sewer





Amenities & Features

Cooling: Central Air

Fireplaces Total: 1

Fireplace Features: Electric

