

Basement

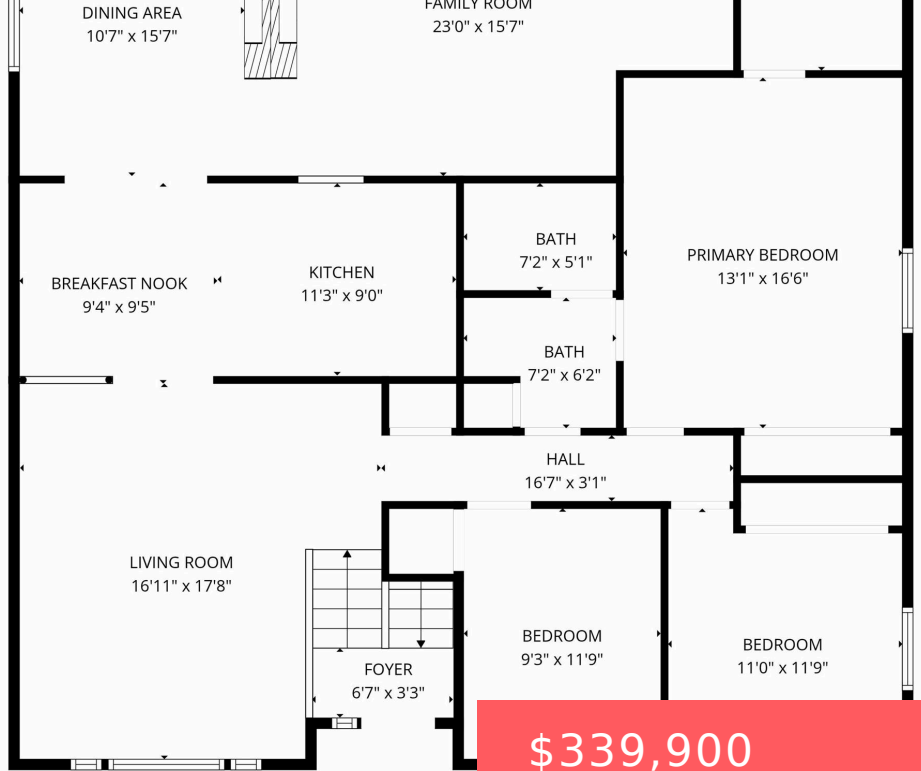

\$339,900

- 3 beds
- 1 bath
- Residential
- None, Single Family Residence
- Active - Active
- 2141 sq ft

805 ROHL DR

<https://harr-lemme.com>

Basics

Status: Active - Active

Category: None, Single Family Residence

Date added: Added 3 days ago

Bathrooms: 1 bath

Total rooms: 7

Year built: 1975

Type: Residential

Sale Or Rent: S

Bedrooms: 3 beds

Half baths: 0 half baths

Area, sq ft: 2141 sq ft

MLS ID: 22603549

Schools



School District: Sioux Falls

Middle: Ben Reifel Middle School

High School District: Sioux Falls

Elementary: Cleveland ES

High School: Washington HS

Middle Or Junior School District: Sioux Falls

Agent

AgentEmail: jon@vigorrealty.net

AgentMI: D

AgentFirstName: Jon

AgentLastName: Fick

Building Details

Architectural Style: Split Foyer

Construction Materials: Metal

Heating: Natural Gas

Parcel Number: 033811

Basement: Partial

Sewer: Public Sewer

Subdivision Name: Grandview Park Addn

Parking: 2

Foundation Details: Block

Water Source: Public

Floor covering: Carpet, Ceramic Tile

Roof: Composition

Lot Features: Garden

Amenities & Features

Cooling: Central Air

Fireplace Features: Gas

Patio And Porch Features: Deck

Fireplaces Total: 1

Fencing: Chain Link

