



**\$339,900.00**

## **787 70TH AVE**

<https://harr-lemme.com>

As described per parcel #02-0182.000

- 4 beds
- 3 baths
- Single Family, Two Story
- None, RESIDENTIAL
- Active
- 3216 sq ft

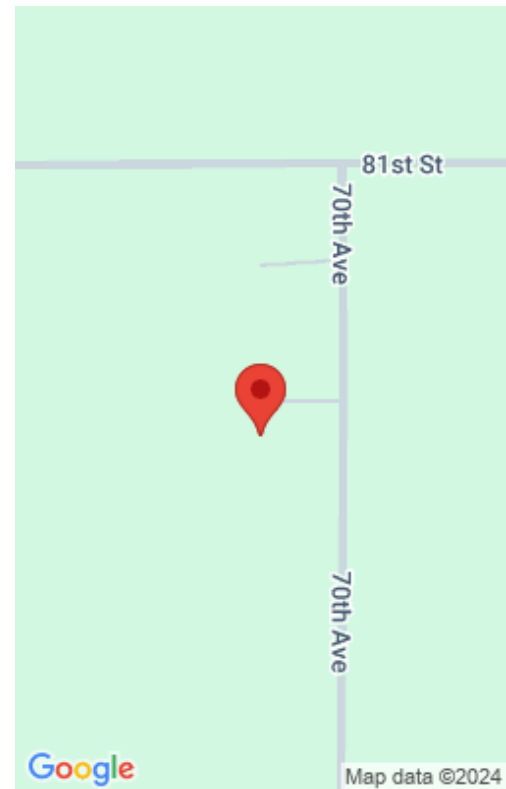

---

## Basics

**Category:** None, RESIDENTIAL

**Status:** Active

**Bathrooms:** 3 baths

**Floor level:** 1608

**Lot size:** 228690 sq ft

**Type:** Single Family, Two Story

**Bedrooms:** 4 beds

**Total rooms:** 9

**Area:** 3216 sq ft

**Year built:** 1926

---

## Schools

**School District:** Minnesota

**Middle:** Hills Beaver Creek MS

**Elementary:** Hills Beaver Creek ES

**High School:** Hills Beaver Creek HS

---

## Agent

**AgentEmail:** keith@realestateretrievers.com

**AgentMI:** A

**AgentPhoneNumber:** 507-920-6131

**AgentFirstName:** Keith

**AgentLastName:** Elbers

---

## Building Details

**Floor covering:** Carpet, Vinyl

**Exterior material:** Wood

**Parking:** Attached, Detached

**Basement:** Full

**Roof:** Shingle Composition

---

## Amenities & Features

**Features:** 3+ Bedrooms Same Level, 9 FT+ Ceiling in Lwr Lvl, Formal Dining Rm, Main Floor Laundry



---

# Realty Office

**Office Name:** Real Estate Retrievers

**Office City:** Luverne

**Office State:** MN

**Office Phone:** 507-283-4216

**Office Email:** deb@realestateretrievers.com

**Office Website:** www.realestateretrievers.com

