

OPEN HOUSE

SATURDAY OCTOBER 4TH, 2025

\$850,000

UNDEFINED UNDEFINED

<https://harr-lemme.com>

TRACT 4 JASIMINE'S ADD SE1/4 14-99-50



Chad Hettermann

- 4 beds
- 3 baths
- Ranch, Single Family
- Outside City Limits, RESIDENTIAL
- Active
- 2843 sq ft

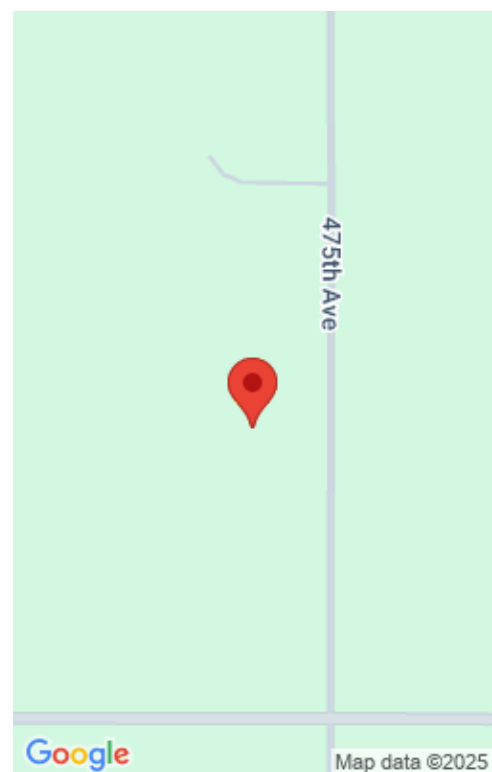

Basics

Category: Outside City Limits, RESIDENTIAL

Status: Active

Bathrooms: 3 baths

Floor level: 1576

Lot size: 261360 sq ft

Type: Ranch, Single Family

Bedrooms: 4 beds

Total rooms: 11

Area: 2843 sq ft

Year built: 2021

Schools

School District: Canton 41-1 **Elementary:** Lawrence Elementary School - Canton School District 41-1

Middle: Canton MS

High School: Canton HS

Agent

AgentEmail: chad@foundationrealestatesd.com

AgentMI: E

AgentPhoneNumber: 605-799-5035

AgentFirstName: Chad

AgentLastName: Hettermann

Building Details

Floor covering: Carpet, Tile, Wood

Exterior material: Hard Board, Part Brick

Parking: Attached

Basement: Full

Roof: Shingle Composition

Amenities & Features

Features: Main Floor Laundry, Master Bath, Master Bed Main Level, Pantry, Tray Ceiling



Realty Office

Office Name: Foundation Real Estate

Office State: SD

Office Email: chad@foundationrealestatesd.com

Office City: Sioux Falls

Office Phone: 605-799-5035

