



\$1,500,000

WESSINGTON SPRINGS, SD, 57382

<https://harr-lemme.com>

Id 3540 is NW3-107-67 and ID 3541 is SW 3-107-67

- 3 beds
- 1 bath
- Ranch, Single Family
- Outside City Limits, RESIDENTIAL
- Active
- 800 sq ft

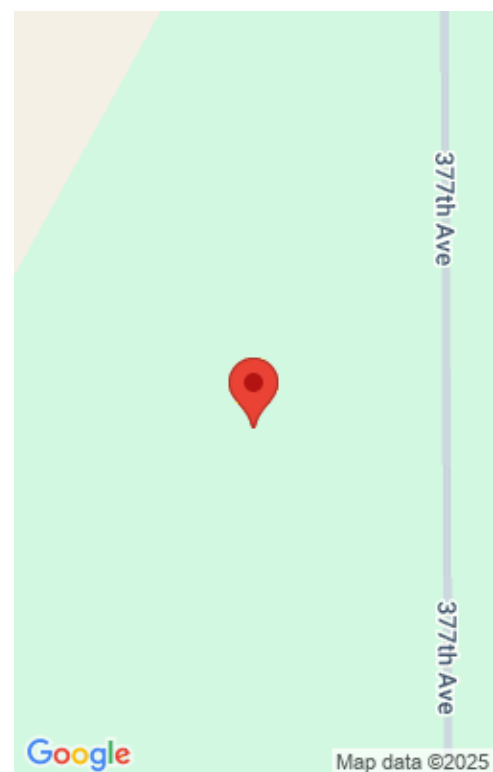

Basics

Category: Outside City Limits, RESIDENTIAL
Status: Active
Bathrooms: 1 bath
Floor level: 800
Lot size: 13885621 sq ft

Type: Ranch, Single Family
Bedrooms: 3 beds
Total rooms: 7
Area: 800 sq ft
Year built: 2019

Schools

School District: Wessington Springs
Middle: Wessington Springs MS

Elementary: Wessington Springs ES
High School: Wessington Springs HS

Agent

AgentEmail: swick7240@gmail.com
AgentMI: D
AgentPhoneNumber: 605-728-4614

AgentFirstName: Scott
AgentLastName: Wick

Building Details

Floor covering: Laminate, Vinyl
Exterior material: Metal

Basement: None
Roof: Metal

Amenities & Features

Features: Vaulted Ceiling



Realty Office

Office Name: Berkshire Hathaway HomeServices Midwest Realty - Sioux Falls

Office State: SD

Office Email: info@bhhssiouxfalls.com

Office City: Sioux Falls

Office Phone: 605-274-1034

Office Website: bhhs.com

