



**\$379,999.00**

## **521 LANEY LN**

<https://harr-lemme.com>

Lot 9 Block 3 Grant Park Addn To City Of Baltic

- 4 beds
- 2 baths
- Single Family, Split Foyer
- New Construction, RESIDENTIAL
- Active, Active - Contingent Misc, Active-New
- 1796 sq ft

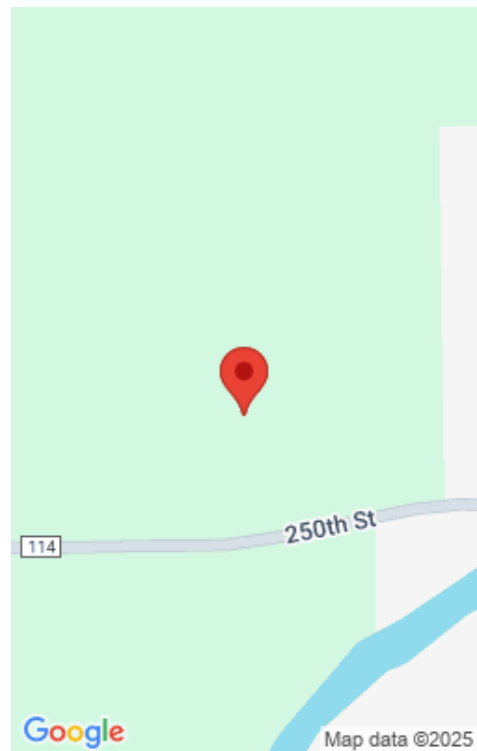

---

## Basics

**Category:** New Construction, RESIDENTIAL

**Status:** Active, Active - Contingent Misc, Active-New

**Bathrooms:** 2 baths

**Floor level:** 1031

**Lot size:** 7920 sq ft

**Type:** Single Family, Split Foyer

**Bedrooms:** 4 beds

**Total rooms:** 8

**Area:** 1796 sq ft

**Year built:** 2024

---

## Schools

**School District:** Baltic 49-1

**Middle:** Baltic MS

**Elementary:** Baltic ES

**High School:** Baltic HS

---

## Agent

**AgentEmail:** maggierichter.preg@gmail.com

**AgentMI:** J

**AgentPhoneNumber:** 605-610-5126

**AgentFirstName:** Maggie

**AgentLastName:** Richter

---

## Building Details

**Floor covering:** Carpet, Laminate

**Exterior material:** Hard Board, Part Brick

**Parking:** Attached

**Basement:** Full

**Roof:** Shingle Composition

---

## Amenities & Features

**Features:** Tray Ceiling



---

# Realty Office

**Office Name:** eXp Realty

**Office State:** SD

**Office Email:** [jon.mehlhoff@exprealty.com](mailto:jon.mehlhoff@exprealty.com)

**Office City:** Rapid City

**Office Phone:** 605-988-6209

**Office Website:** [www.exprealty.com](http://www.exprealty.com)

