

FLOOR 1

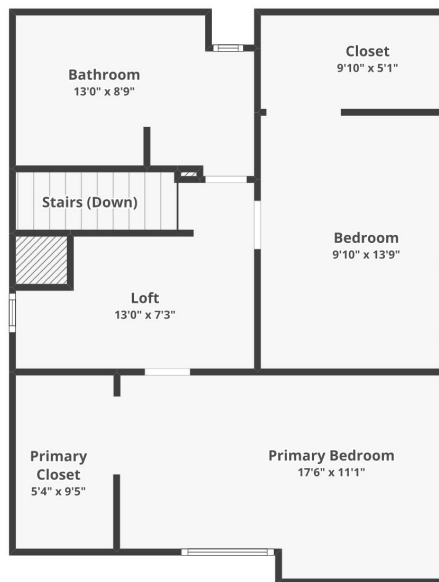

FLOOR 2

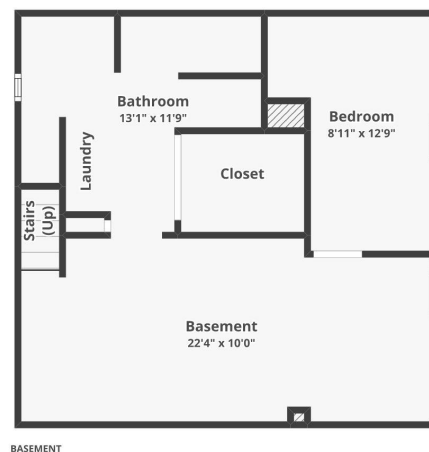

BASEMENT

\$219,900

- 2 beds
- 0 baths
- Residential
- None, Single Family Residence
- Active - Active
- 1601 sq ft

517 WALTS AVE

<https://harr-lemme.com>

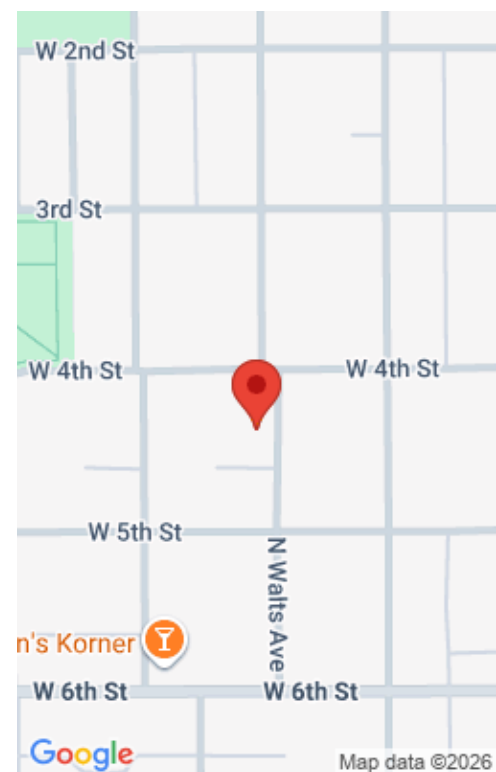

Basics

Status: Active - Active

Category: None, Single Family Residence

Date added: Added 10 hours ago

Bathrooms: 0 baths

Total rooms: 8

Year built: 1910

Type: Residential

Sale Or Rent: S

Bedrooms: 2 beds

Half baths: 0 half baths

Area, sq ft: 1601 sq ft

MLS ID: 22600228

Schools

School District: Sioux Falls

Middle: Patrick Henry MS

High School District: SiouxFalls

Elementary: Hawthorne ES

High School: Lincoln HS

Middle Or Junior School District: SiouxFalls

Agent

AgentEmail: jenny@jennyatkinsonrealestate.com

AgentMI: C

AgentFirstName: Jenny

AgentLastName: Atkinson

Building Details

Architectural Style: 1.5 Story

Construction Materials: Wood Siding

Heating: Natural Gas

Parcel Number: 26619

Basement: Full

Sewer: Public Sewer

Subdivision Name: Blackman's Addn

Parking: 2

Foundation Details: Block

Water Source: Public

Floor covering: Carpet, Laminate, Vinyl

Roof: Composition

Lot Features: City Lot





Amenities & Features

Cooling: Central Air, Window Unit(s)

Fencing: Other

Patio And Porch Features: Deck, 3-Season Porch

