



**\$969,900**

## **48503 256TH ST**

<https://harr-lemme.com>

- 5 beds
- 3 baths
- Residential
- Outside City Limits, Single Family Residence
- Active - Active
- 3868 sq ft

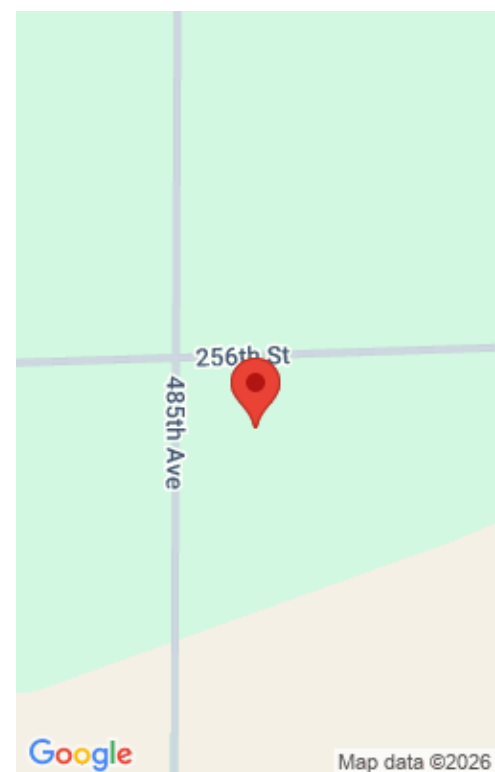

## Basics

<b>Status:</b> Active - Active	<b>Type:</b> Residential
<b>Category:</b> Outside City Limits, Single Family Residence	<b>Sale Or Rent:</b> S
<b>Date added:</b> Added 21 hours ago	<b>Bedrooms:</b> 5 beds
<b>Bathrooms:</b> 3 baths	<b>Half baths:</b> 0 half baths
<b>Total rooms:</b> 13	<b>Area, sq ft:</b> 3868 sq ft
<b>Year built:</b> 2023	<b>MLS ID:</b> 22600610

## Schools

<b>School District:</b> Garretson	<b>Elementary:</b> Garretson ES
<b>Middle:</b> Garretson MS	<b>High School:</b> Garretson HS
<b>High School District:</b> Garretson	<b>Middle Or Junior School District:</b> Garretson

## Agent

<b>AgentEmail:</b> dave@thinkalpine.com	<b>AgentFirstName:</b> Dave
<b>AgentMI:</b> E	<b>AgentLastName:</b> Dreessen

## Building Details

<b>Parking Features:</b> Gravel	<b>Architectural Style:</b> Ranch
<b>Parking:</b> 3	<b>Construction Materials:</b> Wood Siding, Hard Board, Metal
<b>Foundation Details:</b> Poured	<b>Heating:</b> Electric, Heat Pump, Dual Fuel, Zoned, 90% Efficient
<b>Water Source:</b> Rural Water	<b>Parcel Number:</b> 13527
<b>Floor covering:</b> Carpet, Tile, Wood	<b>Basement:</b> Full
<b>Roof:</b> Composition	<b>Sewer:</b> Septic Tank
<b>Lot Features:</b> Walk-Out	<b>Subdivision Name:</b> Red Rock Township



# Amenities & Features

**Cooling:** Central Air

**Fireplace Features:** Gas

**Fireplaces Total:** 1

**Patio And Porch Features:** Porch