



\$1,890,000

48190 265TH ST

<https://harr-lemme.com>

- 7 beds
- 5 baths
- Residential
- Outside City Limits, Single Family Residence
- Active - Active
- 8191 sq ft

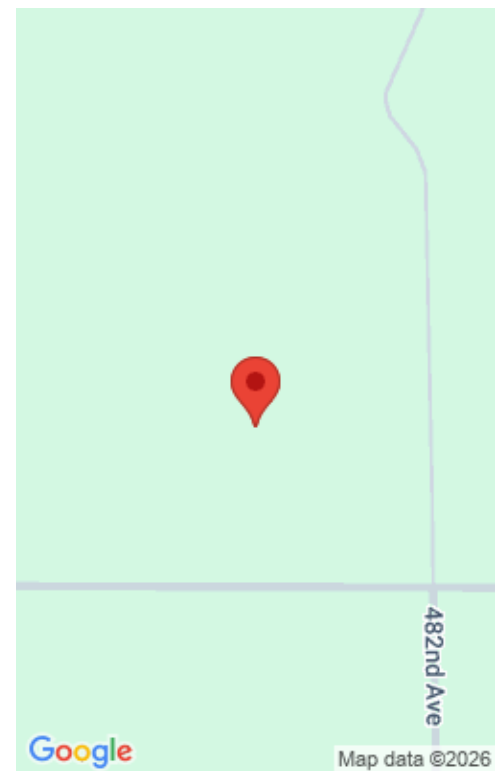

Basics

Status: Active - Active

Category: Outside City Limits, Single Family Residence

Date added: Added 5 days ago

Bathrooms: 5 baths

Total rooms: 27

Year built: 1992

Type: Residential

Sale Or Rent: S

Bedrooms: 7 beds

Half baths: 0 half baths

Area, sq ft: 8191 sq ft

MLS ID: 22604867

Schools

School District: Brandon Valley 49-2

Middle: Brandon Valley MS

High School District: BrandonVal

Elementary: Brandon ES

High School: Brandon Valley HS

Middle Or Junior School District: BrandonVal

Agent

AgentEmail: Spencer@core-companies.com

AgentMI: M

AgentFirstName: Spencer

AgentLastName: Mannes

Building Details



Parking Features: , Concrete, Asphalt

Parking: 5

Foundation Details: Poured

Water Source: Rural Water

Floor covering: Carpet, Laminate, Luxury Vinyl Plank, Other, Tile, Vinyl, Wood

Roof: Composition

Lot Features: Walk-Out

Architectural Style: Two Story

Construction Materials: Brick, Cement Siding

Heating: Propane

Parcel Number: 10804

Basement: Full

Sewer: Septic Tank

Subdivision Name: Hildrings Addn

Amenities & Features

Cooling: Central Air

Fireplace Features: Wood Burning

Fireplaces Total: 1

Patio And Porch Features: , Deck, Covered Patio, Porch, 3-Season Porch, Front Porch

