



\$1,995,000

48190 265TH ST

<https://harr-lemme.com>

- 7 beds
- 1 bath
- Residential
- Outside City Limits, Single Family Residence
- Active - Active
- 8191 sq ft

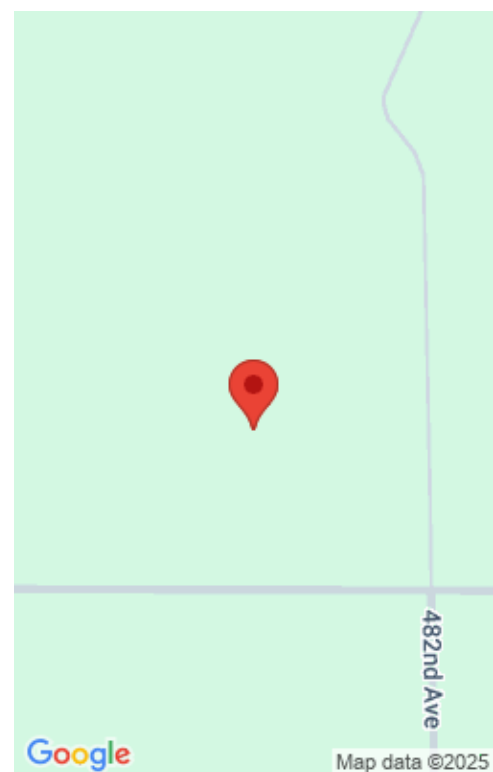

Basics

Status: Active - Active
Category: Outside City Limits, Single Family Residence
Date added: Added 2 months ago
Bathrooms: 1 bath
Total rooms: 27
Year built: 1992
Days On Market: 91

Type: Residential
Sale Or Rent: S
Bedrooms: 7 beds
Half baths: 0 half baths
Area, sq ft: 8191 sq ft
MLS ID: 22507101

Schools

School District: Brandon Valley 49-2	Elementary: Brandon ES
Middle: Brandon Valley MS	High School: Brandon Valley HS
High School District: BrandonVal	Middle Or Junior School District: BrandonVal

Agent

AgentEmail: larsonsellsre@gmail.com	AgentFirstName: Dave
AgentMI: J	AgentLastName: Larson

Building Details



Parking Features: Concrete, Asphalt

Parking: 5

Foundation Details: Poured

Water Source: Rural Water

Floor covering: Carpet, Laminate, Other, Tile, Vinyl, Wood

Roof: Composition

Lot Features: Walk-Out

Architectural Style: Two Story

Construction Materials: Brick, Cement Siding

Heating: Propane

Parcel Number: 10804

Basement: Full

Sewer: Septic Tank

Subdivision Name: Hildrings Addn

Amenities & Features

Cooling: Central Air

Fireplace Features: Wood Burning

Fireplaces Total: 1

Patio And Porch Features: Deck, Covered Patio, Porch, 3-Season Porch, Front Porch

