

BASEMENT

**\$220,000**

**47296 323RD ST**

<https://harr-lemme.com>

- 4 beds
- 1 bath
- Residential
- Outside City Limits, Single Family Residence
- Active - Active
- 1492 sq ft

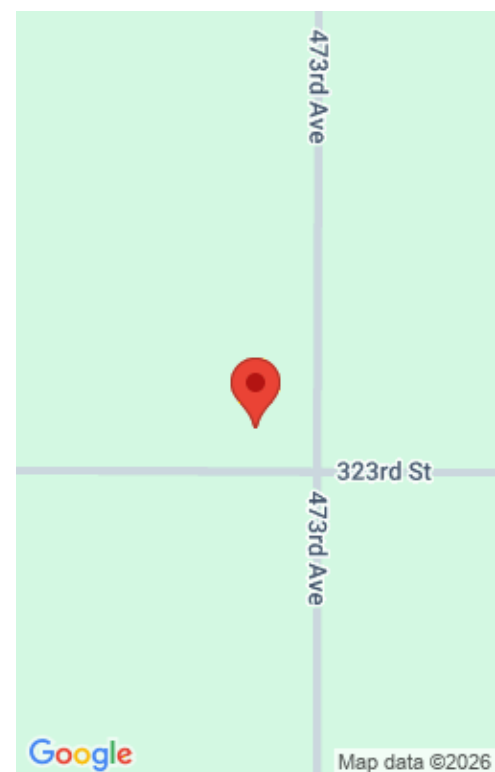

---

# Basics

**Status:** Active - Active

**Category:** Outside City Limits, Single Family Residence

**Date added:** Added 4 hours ago

**Bathrooms:** 1 bath

**Total rooms:** 8

**Year built:** 1950

**Type:** Residential

**Sale Or Rent:** S

**Bedrooms:** 4 beds

**Half baths:** 1 half bath

**Area, sq ft:** 1492 sq ft

**MLS ID:** 22600832

---

# Schools

**School District:** Elk Point-Jefferson

**Elementary:** Elk Point-Jefferson ES

**Middle:** Elk Point-Jefferson MS/HS

**High School:** Elk Point-Jefferson MS/HS

**High School District:** ElkPointJe

**Middle Or Junior School District:** ElkPointJe

---

# Agent

**AgentEmail:** michaeljschmidt@kw.com

**AgentFirstName:** Michael

**AgentMI:** J

**AgentLastName:** Schmidt

---

# Building Details

**Parking Features:** Gravel

**Architectural Style:** 1.5 Story

**Parking:** 2

**Construction Materials:** Metal, Vinyl Siding

**Foundation Details:** Block

**Heating:** Electric

**Water Source:** Rural Water

**Parcel Number:** 15.00.09.8015

**Floor covering:** Carpet, Wood

**Basement:** Full

**Roof:** Metal

**Sewer:** Septic Tank

**Lot Features:** Irregular Lot

**Subdivision Name:** No Subdivision





# Amenities & Features

**Cooling:** Central Air

**Patio And Porch Features:** Deck

