



**\$495,900**

## **46826 295TH ST**

<https://harr-lemme.com>

- 5 beds
- 2 baths
- Residential
- Outside City Limits, Single Family Residence
- Active - Active
- 2430 sq ft

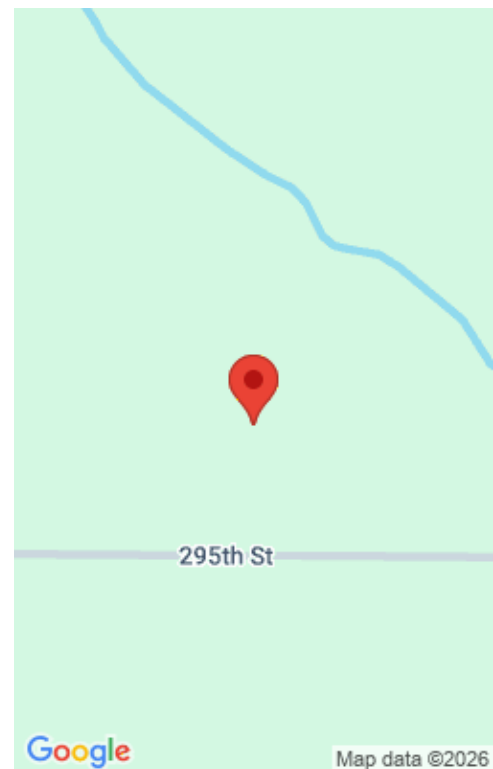

---

# Basics

<b>Status:</b> Active - Active	<b>Type:</b> Residential
<b>Category:</b> Outside City Limits, Single Family Residence	<b>Sale Or Rent:</b> S
<b>Date added:</b> Added 3 months ago	<b>Bedrooms:</b> 5 beds
<b>Bathrooms:</b> 2 baths	<b>Half baths:</b> 0 half baths
<b>Area, sq ft:</b> 2430 sq ft	<b>Year built:</b> 1906
<b>MLS ID:</b> 22507036	<b>Days On Market:</b> 80

---

# Schools

<b>School District:</b> Beresford 61-2	<b>Elementary:</b> Beresford ES
<b>Middle:</b> Beresford MS	<b>High School:</b> Beresford HS
<b>High School District:</b> Beresford	<b>Middle Or Junior School District:</b> Beresford

---

# Agent

<b>AgentEmail:</b> shawn@bhhsmidwestrealty.com	<b>AgentFirstName:</b> Shawn
<b>AgentMI:</b> D	<b>AgentLastName:</b> Giedd

---

# Building Details

<b>Parking Features:</b> Gravel	<b>Architectural Style:</b> Two Story
<b>Parking:</b> 2	<b>Construction Materials:</b> Hard Board, Vinyl Siding
<b>Foundation Details:</b> Block, Other	<b>Heating:</b> Propane, 90% Efficient
<b>Water Source:</b> Rural Water	<b>Parcel Number:</b> 096.51.23.B200
<b>Floor covering:</b> Carpet, Vinyl	<b>Basement:</b> Crawl Space, Partial
<b>Roof:</b> Composition	<b>Sewer:</b> Septic Tank
<b>Subdivision Name:</b> No Subdivision	



# Amenities & Features

**Cooling:** Multi Units

**Fireplace Features:** Gas

**Patio And Porch Features:** Front Porch

**Fireplaces Total:** 1

**Fencing:** Other