



**\$525,000**

**46826 295TH ST**

<https://harr-lemme.com>

**LOT 2 SUING'S ADD S1/2SW1/4 23-96-51**



**Shawn Giedd**

- 5 beds
- 2 baths
- Single Family, Two Story
- Outside City Limits, RESIDENTIAL
- Active
- 2430 sq ft

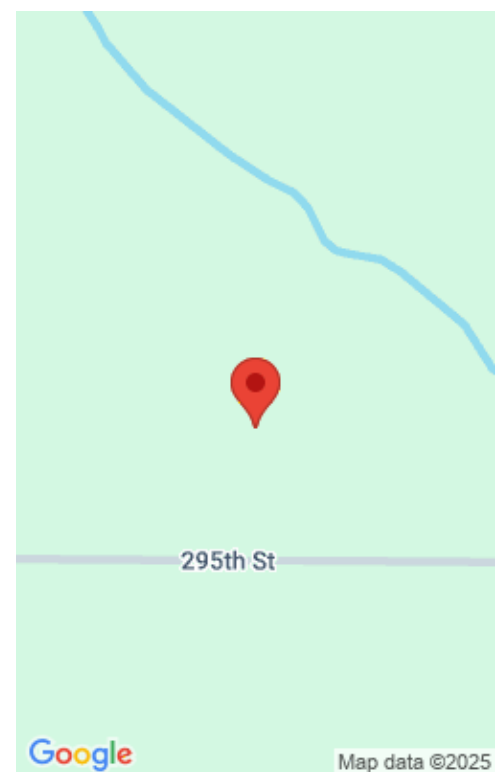

---

## Basics

**Category:** Outside City Limits, RESIDENTIAL

**Status:** Active

**Bathrooms:** 2 baths

**Area:** 2430 sq ft

**Year built:** 1906

**Type:** Single Family, Two Story

**Bedrooms:** 5 beds

**Floor level:** 1650

**Lot size:** 464783 sq ft

---

## Schools

**School District:** Beresford 61-2

**Middle:** Beresford MS

**Elementary:** Beresford ES

**High School:** Beresford HS

---

## Agent

**AgentEmail:** shawn@bhhsmidwestrealty.com

**AgentMI:** D

**AgentPhoneNumber:** 605-660-1684

**AgentFirstName:** Shawn

**AgentLastName:** Giedd

---

## Building Details

**Floor covering:** Carpet, Vinyl

**Exterior material:** Hard Board, Vinyl

**Parking:** Detached

**Basement:** Crawl Space, Partial

**Roof:** Shingle Composition

---

## Amenities & Features

**Features:** 3+ Bedrooms Same Level, Formal Dining Rm, Master Bed Main Level



---

## Realty Office

**Office Name:** Berkshire Hathaway HomeServices Midwest Realty - Sioux Falls

**Office State:** SD

**Office Email:** [info@bhhssiouxfalls.com](mailto:info@bhhssiouxfalls.com)

**Office City:** Sioux Falls

**Office Phone:** 605-274-1034

**Office Website:** [bhhs.com](http://bhhs.com)

