



**\$699,900.00**

## **46736 306TH ST**

<https://harr-lemme.com>

**PETERSON FARM TRACT 1 IN SE 1/4 SW 1/4 15-94-51 GARFIELD  
TWP**

- 4 beds
- 3 baths
- Ranch, Single Family
- None, RESIDENTIAL
- Active, Active-New
- 2391 sq ft

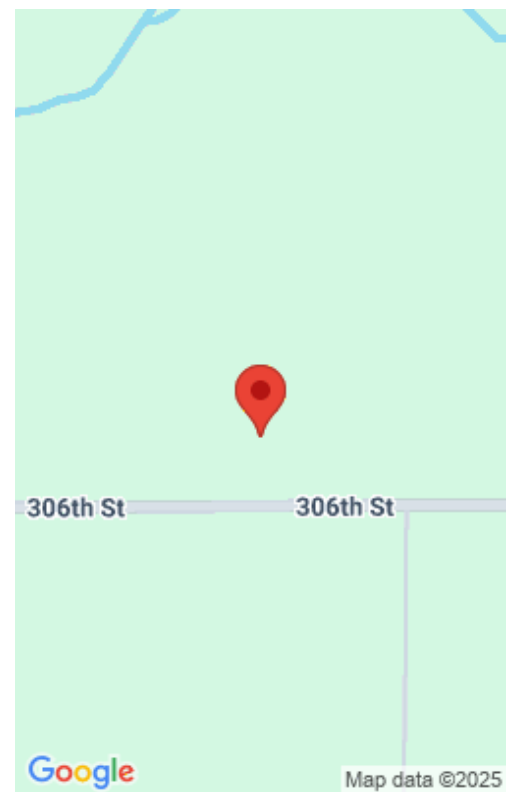

---

## Basics

**Category:** None, RESIDENTIAL

**Status:** Active, Active-New

**Bathrooms:** 3 baths

**Floor level:** 2391

**Lot size:** 100188 sq ft

**Type:** Ranch, Single Family

**Bedrooms:** 4 beds

**Total rooms:** 10

**Area:** 2391 sq ft

**Year built:** 2022

---

## Schools

**School District:** Beresford 61-2

**Middle:** Beresford MS

**Elementary:** Beresford ES

**High School:** Beresford HS

---

## Agent

**AgentEmail:** mandra@bhhs-midwestrealty.com

**AgentMI:** L

**AgentPhoneNumber:** 605-777-3039

**AgentFirstName:** Mandra

**AgentLastName:** Kruse

---

## Building Details

**Floor covering:** Carpet, Luxury Vinyl Plank

**Exterior material:** Hard Board

**Parking:** Attached

**Basement:** None

**Roof:** Shingle Composition

---

## Amenities & Features

**Features:** 3+ Bedrooms Same Level, Formal Dining Rm, Main Floor Laundry, Master Bath, Master Bed Main Level, Pantry, Tray Ceiling, Vaulted Ceiling



---

## Realty Office

**Office Name:** Berkshire Hathaway HomeServices Midwest Realty - Sioux Falls

**Office State:** SD

**Office Email:** [info@bhhssiouxfalls.com](mailto:info@bhhssiouxfalls.com)

**Office City:** Sioux Falls

**Office Phone:** 605-274-1034

**Office Website:** [bhhs.com](http://bhhs.com)

