



**\$689,900**

## **BERESFORD, SD, 57004**

<https://harr-lemme.com>

**PETERSON FARM TRACT 1 IN SE 1/4 SW 1/4 15-94-51 GARFIELD  
TWP**

- 4 beds
- 3 baths
- Ranch, Single Family
- None, RESIDENTIAL
- Active
- 2391 sq ft

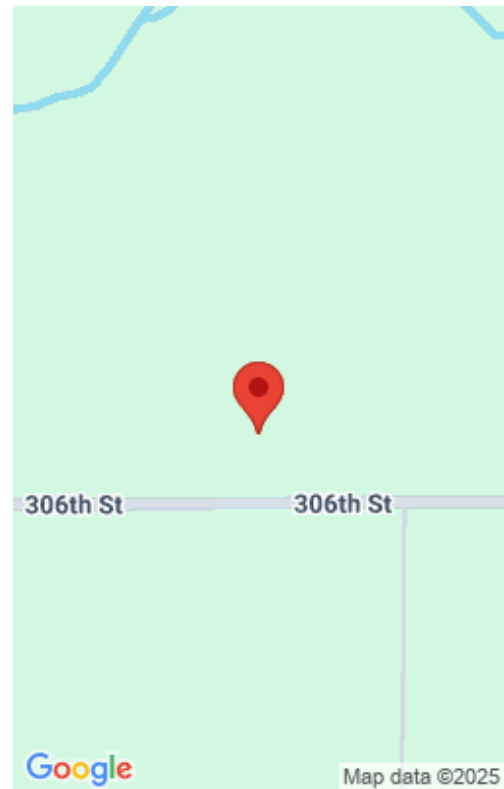

---

# Basics

**Category:** None, RESIDENTIAL  
**Status:** Active  
**Bathrooms:** 3 baths  
**Floor level:** 2391  
**Lot size:** 100188 sq ft

**Type:** Ranch, Single Family  
**Bedrooms:** 4 beds  
**Total rooms:** 10  
**Area:** 2391 sq ft  
**Year built:** 2022

---

# Schools

**School District:** Beresford 61-2  
**Middle:** Beresford MS

**Elementary:** Beresford ES  
**High School:** Beresford HS

---

# Agent

**AgentEmail:** mandra@bhhsmidwestrealty.com  
**AgentMI:** L  
**AgentPhoneNumber:** 605-777-3039

**AgentFirstName:** Mandra  
**AgentLastName:** Kruse

---

# Building Details

**Floor covering:** Carpet, Luxury Vinyl Plank  
**Exterior material:** Hard Board  
**Parking:** Attached

**Basement:** None  
**Roof:** Shingle Composition

---

# Amenities & Features

**Features:** 3+ Bedrooms Same Level, Formal Dining Rm, Main Floor Laundry, Master Bath, Master Bed Main Level, Pantry, Tray Ceiling, Vaulted Ceiling



---

## Realty Office

**Office Name:** Berkshire Hathaway HomeServices Midwest Realty - Sioux Falls

**Office State:** SD

**Office Email:** [info@bhhssiouxfalls.com](mailto:info@bhhssiouxfalls.com)

**Office City:** Sioux Falls

**Office Phone:** 605-274-1034

**Office Website:** [bhhs.com](http://bhhs.com)

