



\$899,900

TEA, SD, 57064

<https://harr-lemme.com>

Tract 3 lot 7 of Peters Addn.

- 4 beds
- 3 baths
- Shouse, Single Family
- New Construction, RESIDENTIAL
- Active
- 2683 sq ft

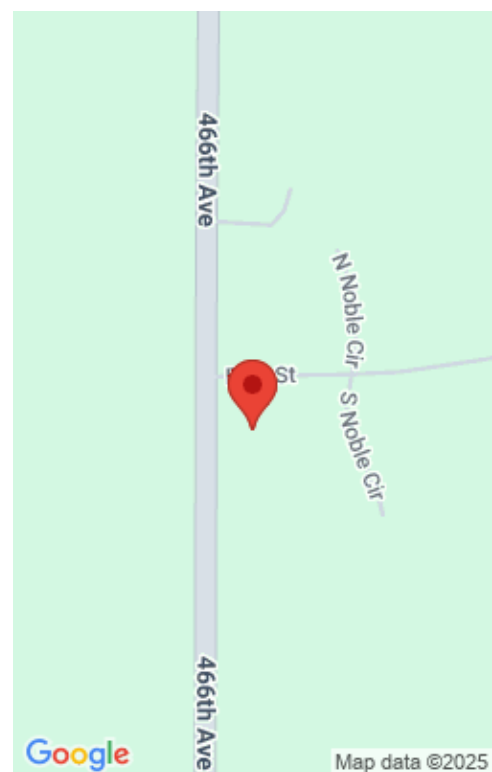

Basics

Category: New Construction, RESIDENTIAL
Status: Active
Bathrooms: 3 baths
Floor level: 2040
Lot size: 58857 sq ft

Type: Shouse, Single Family
Bedrooms: 4 beds
Total rooms: 10
Area: 2683 sq ft
Year built: 2024

Schools

School District: Lennox
Middle: Lennox MS

Elementary: Lennox ES
High School: Lennox HS

Agent

AgentEmail: eddie@hegg.com
AgentMI: D
AgentPhoneNumber: 605-261-2224

AgentFirstName: Eddie
AgentLastName: Ehlers

Building Details

Floor covering: Carpet, Heated, Luxury Vinyl Plank, Tile
Exterior material: Metal, Stone/Stone Veneer
Parking: Attached

Basement: None
Roof: Metal

Amenities & Features

Amenities: Road Maint **Features:** 3+ Bedrooms Same Level, Main Floor Laundry, Master Bath, Master Bed Main Level, Pantry, Vaulted Ceiling



Realty Office

Office Name: Hegg, REALTORS

Office State: SD

Office Email: tina@hegg.com

Office City: Sioux Falls

Office Phone: 605-336-2100

Office Website: www.hegg.com

