



\$1,279,000.00

46493 258 ST

<https://harr-lemme.com>

TR 1 SMITH ADD (EX H-1) NE14 NE14 14102 51 HARTFORD TOWNSHIP
102-51

- 5 beds
- 3 baths
- Ranch, Single Family
- Outside City Limits, RESIDENTIAL
- Active, Active-New
- 3416 sq ft

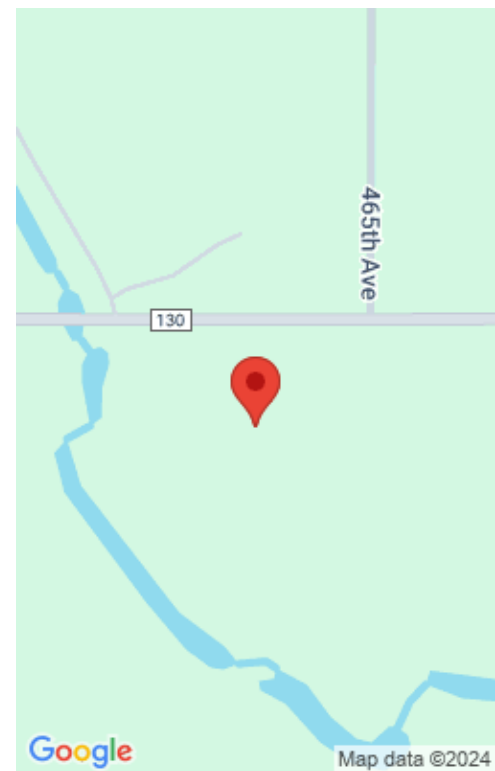

Basics

Category: Outside City Limits, RESIDENTIAL

Status: Active, Active-New

Bathrooms: 3 baths

Floor level: 1816

Lot size: 424710 sq ft

Type: Ranch, Single Family

Bedrooms: 5 beds

Total rooms: 11

Area: 3416 sq ft

Year built: 2004

Schools

School District: West Central 49-7

Middle: West Central MS

Elementary: West Central ES

High School: West Central HS

Agent

AgentEmail: melissamerchant@kw.com

AgentMI: S

AgentPhoneNumber: 605-759-4161

AgentFirstName: Melissa

AgentLastName: Merchant

Building Details

Floor covering: Carpet, Laminate, Tile

Exterior material: Hard Board

Parking: Attached, Detached

Basement: Full

Roof: Shingle Composition

Amenities & Features

Features: 3+ Bedrooms Same Level, Main Floor Laundry, Master Bath, Master Bed Main Level



Realty Office

Office Name: Keller Williams Realty Sioux Falls

Office State: SD

Office Email: klrw923@kw.com

Office City: Sioux Falls

Office Phone: 605-275-0555

Office Website: siouxfalls.yourkwoffice.com/

