



\$409,000

412 ALMOND AVE

<https://harr-lemme.com>

- 3 beds
- 2 baths
- Residential
- New Construction, Townhouse
- Active - Active
- 1480 sq ft

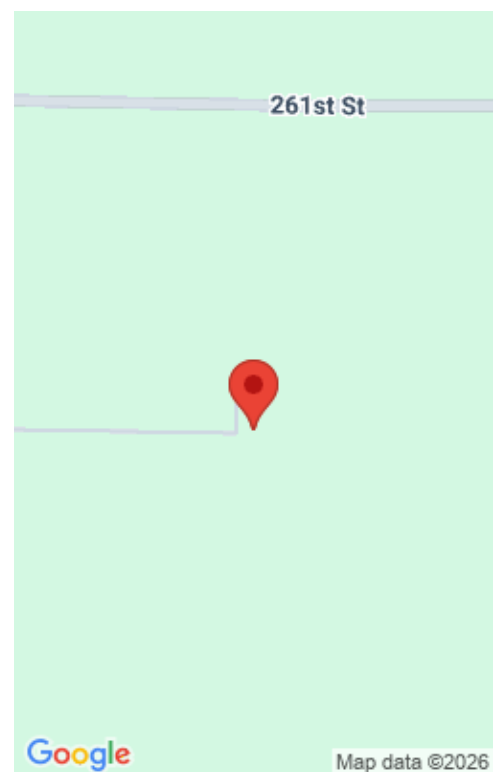

Basics

Status: Active - Active
Category: New Construction, Townhouse
Date added: Added 2 months ago
Bathrooms: 2 baths
Total rooms: 8
Year built: 2025
Days On Market: 61

Type: Residential
Sale Or Rent: S
Bedrooms: 3 beds
Half baths: 0 half baths
Area, sq ft: 1480 sq ft
MLS ID: 22508399

Schools

School District: Brandon Valley 49-2	Elementary: Robert Bennis ES
Middle: Brandon Valley MS	High School: Brandon Valley HS
High School District: BrandonVal	Middle Or Junior School District: BrandonVal

Agent

AgentEmail: realpro22@gmail.com	AgentFirstName: Chuck
AgentMI: A	AgentLastName: Moss

Building Details



Parking Features: Concrete

Parking: 2

Foundation Details: Poured, Slab

Water Source: Public

Floor covering: Carpet, Heated, Tile

Roof: Composition

Lot Features: Irregular Lot, City Lot, Garden

Architectural Style: Ranch

Construction Materials: Brick, Cement Siding

Heating: Natural Gas, 90% Efficient

Parcel Number: 100244

Basement: None

Sewer: Public Sewer

Subdivision Name: CHESTNUT RIDGE ADDN TO THE CITY OF BRANDON

Amenities & Features

Cooling: Central Air

Fireplace Features: Gas

Fireplaces Total: 1

Patio And Porch Features: Deck, Front Porch

