



\$365,000

BALTIC, SD, 57003

<https://harr-lemme.com>

Lot 1 of Block 3 of Phillips Crossing Addn. to the city of Baltic



Jenny Skotvold

- 2 beds
- 2 baths
- Ranch, Single Family
- New Construction, RESIDENTIAL
- Active
- 1203 sq ft

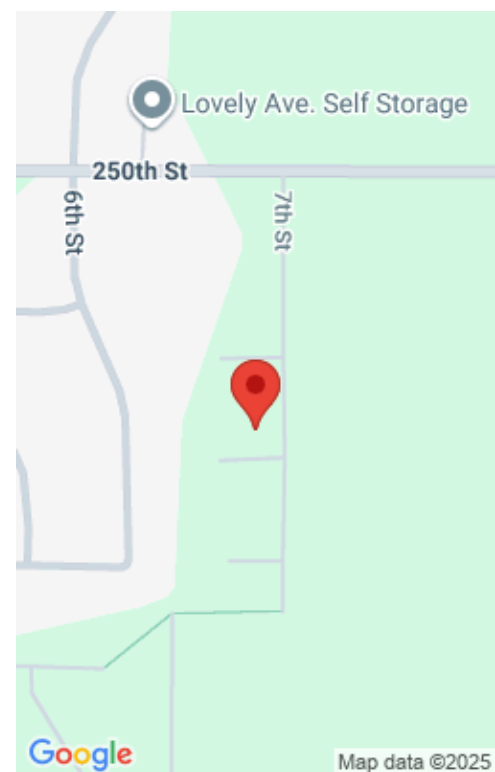

Basics

Category: New Construction, RESIDENTIAL
Status: Active
Bathrooms: 2 baths
Floor level: 1203
Lot size: 10155 sq ft

Type: Ranch, Single Family
Bedrooms: 2 beds
Total rooms: 2
Area: 1203 sq ft
Year built: 2025

Schools

School District: Baltic 49-1
Middle: Baltic MS

Elementary: Baltic ES
High School: Baltic HS

Agent

AgentEmail: jennyskotvold@gmail.com
AgentMI: M
AgentPhoneNumber: 605-360-7269

AgentFirstName: Jenny
AgentLastName: Skotvold

Building Details

Floor covering: Carpet, Luxury Vinyl Plank
Parking: Attached

Roof: Shingle Composition

Amenities & Features

Features: Main Floor Laundry, Master Bed Main Level, Vaulted Ceiling



Realty Office

Office Name: eXp Realty

Office State: SD

Office Email: jon.mehlhoff@exprealty.com

Office City: Rapid City

Office Phone: 605-988-6209

Office Website: www.exprealty.com

