

**\$2,464,000**

- Land
- Outside City Limits
- Active - Active

**386TH AVE**

<https://harr-lemme.com>

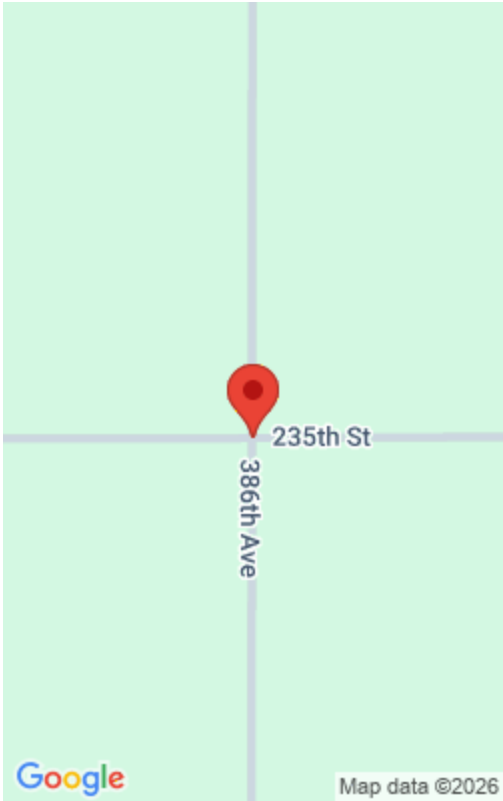

---

## Basics

**Status:** Active - Active

**Category:** Outside City Limits

**Date added:** Added 5 days ago

**Type:** Land

**Sale Or Rent:** S

**MLS ID:** 22604575

---

## Schools

**School District:** Wessington Springs

**Middle:** Wessington Springs MS

**High School District:** Wessington

**Elementary:** Wessington Springs ES

**High School:** Wessington Springs HS

**Middle Or Junior School District:** Wessington

---

## Agent

**AgentEmail:** justinlm.realtor@gmail.com

**AgentMI:** L

**AgentFirstName:** Justin

**AgentLastName:** Morrison

---

## Building Details

**Water Source:** Well

**Utilities:** None

**Subdivision Name:** No Subdivision

**Parcel Number:** 001832, 001835, 001830, 001829

**Sewer:** None

---

## Amenities & Features

**Fencing:** Combination Fencing

