



\$340,000.00

320 N BRIDGE ST

<https://harr-lemme.com>

Canton-Petersons Sub Tr 1 & N 54' Of W 118' O.L. 7 Fitz Sub

- 3 beds
- 2 baths
- Ranch, Single Family
- None, RESIDENTIAL
- Active, Active-New
- 1420 sq ft

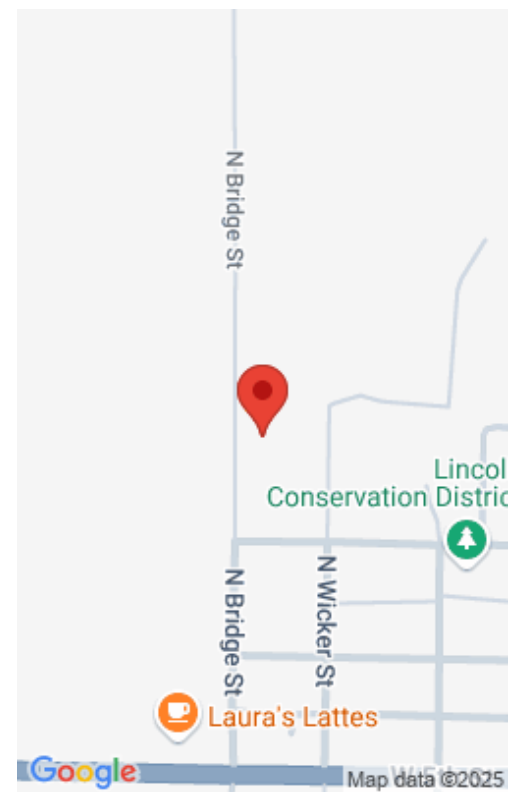

Basics

Category: None, RESIDENTIAL

Status: Active, Active-New

Bathrooms: 2 baths

Floor level: 1420

Lot size: 18861 sq ft

Type: Ranch, Single Family

Bedrooms: 3 beds

Total rooms: 9

Area: 1420 sq ft

Year built: 1977

Schools

School District: Canton 41-1 **Elementary:** Lawrence Elementary School - Canton School District 41-1

Middle: Canton MS

High School: Canton HS

Agent

AgentEmail: dkmettler@sio.midco.net

AgentMI: H

AgentPhoneNumber: 605-366-4192

AgentFirstName: David

AgentLastName: Mettler

Building Details

Floor covering: Carpet, Vinyl

Exterior material: Full Brick Front, Vinyl

Parking: Attached

Basement: Full

Roof: Shingle Composition

Amenities & Features

Features: 3+ Bedrooms Same Level, Main Floor Laundry, Master Bath, Master Bed Main Level



Realty Office

Office Name: Keller Williams Realty Sioux Falls

Office State: SD

Office Email: klrw923@kw.com

Office City: Sioux Falls

Office Phone: 605-275-0555

Office Website: siouxfalls.yourkwoffice.com/

