



\$639,000

ALCESTER, SD, 57001

<https://harr-lemme.com>

Schreur's Tract 1, Ne1/4, Ne1/4, 7-94N-49W, (Big Springs Twnshp)

- 3 beds
- 3 baths
- Other, Single Family
- Outside City Limits, RESIDENTIAL
- Active
- 2988 sq ft

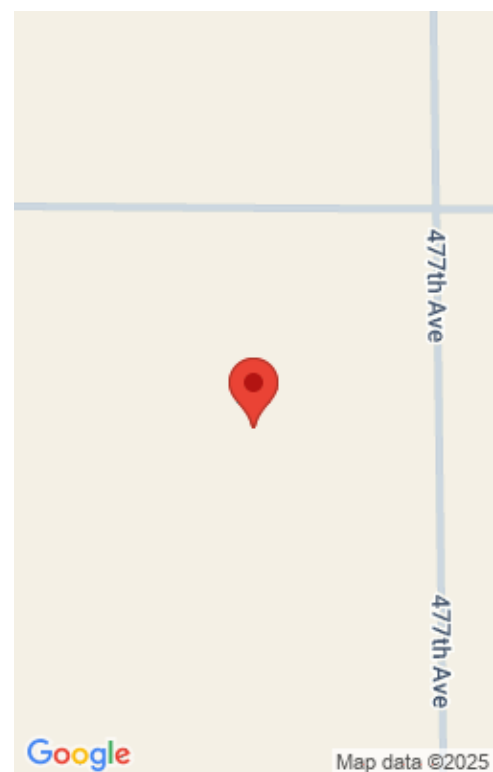

Basics

Category: Outside City Limits, RESIDENTIAL

Status: Active

Bathrooms: 3 baths

Floor level: 1562

Lot size: 306227 sq ft

Type: Other, Single Family

Bedrooms: 3 beds

Total rooms: 10

Area: 2988 sq ft

Year built: 2015

Schools

School District: Alcester-Hudson 61-1

Middle: Alcester-Hudson JHS

Elementary: Alcester-Hudson ES

High School: Alcester-Hudson HS

Agent

AgentEmail: TWing65698@aol.com

AgentMI: L

AgentPhoneNumber: 605-728-3067

AgentFirstName: Terry

AgentLastName: Wingler

Building Details

Floor covering: Carpet, Ceramic, Heated, Laminate

Exterior material: Hard Board, Part Brick

Parking: Attached

Basement: Full

Roof: Shingle Composition

Amenities & Features

Features: Master Bath, Master Bed Main Level, Pantry, Tray Ceiling, Vaulted Ceiling



Realty Office

Office Name: Dakota Country Realty

Office State: SD

Office Email: twing65698@aol.com

Office City: Sioux Falls

Office Phone: 605-334-5678

