



\$375,000

2909 LANA DR

<https://harr-lemme.com>

- 4 beds
- 3 baths
- Residential
- New Construction, Single Family Residence
- Active - Active
- 1876 sq ft

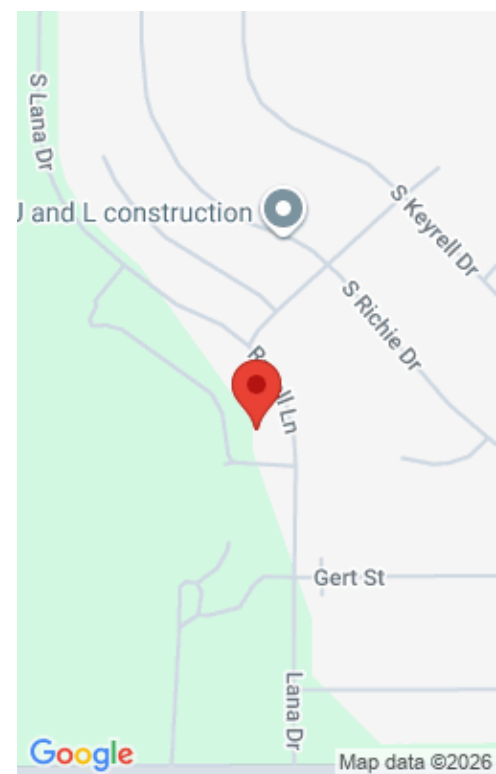

Basics

Status: Active - Active

Category: New Construction, Single Family Residence

Date added: Added 3 days ago

Bathrooms: 3 baths

Total rooms: 8

Year built: 2023

Type: Residential

Sale Or Rent: S

Bedrooms: 4 beds

Half baths: 0 half baths

Area, sq ft: 1876 sq ft

MLS ID: 22600299

Schools

School District: Tea Area

Elementary: Frontier Elementary School - Tea

Middle: Tea MS

High School: Tea HS

High School District: TeaArea

Middle Or Junior School District: TeaArea

Agent

AgentEmail: ryan@605advantage.com

AgentFirstName: Ryan

AgentMI: R

AgentLastName: Olson

Building Details

Parking Features: Concrete

Architectural Style: Split Foyer

Parking: 2

Construction Materials: Brick, Hard Board

Foundation Details: Poured

Heating: Natural Gas

Water Source: Public

Parcel Number: 96409

Floor covering: Carpet, Vinyl

Basement: Full

Roof: Composition

Sewer: Public Sewer

Lot Features: Irregular Lot, City Lot

Subdivision Name: WESTWOOD VALLEY 2ND ADDITION TO THE CITY OF SIOUX FALLS





Amenities & Features

Cooling: Central Air

Patio And Porch Features: Deck

