



**\$364,900.00**

## **2805 S LANA DR**

<https://harr-lemme.com>

Lot 2 Blck 24 Westwood Valley 2nd Addn to the City of Sioux Falls

- 4 beds
- 3 baths
- Ranch, Single Family
- None, RESIDENTIAL
- Active, Active - Contingent Misc, Active-New
- 1876 sq ft

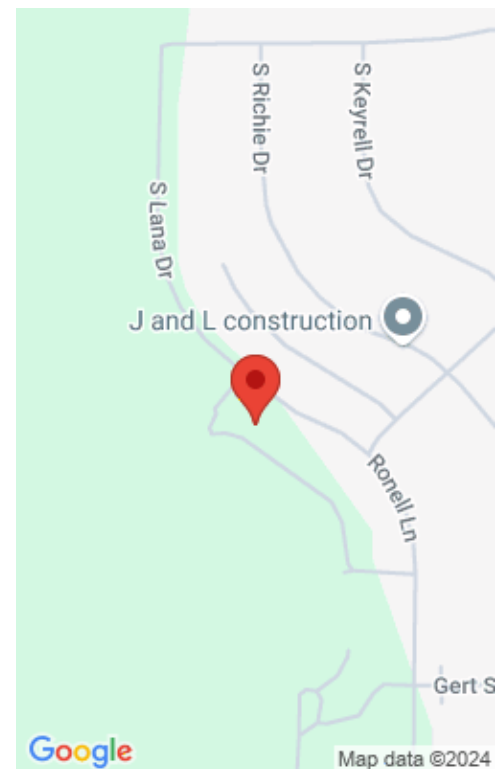

---

## Basics

**Category:** None, RESIDENTIAL

**Status:** Active, Active - Contingent Misc, Active-New

**Bathrooms:** 3 baths

**Floor level:** 1076

**Lot size:** 6456 sq ft

**Type:** Ranch, Single Family

**Bedrooms:** 4 beds

**Total rooms:** 8

**Area:** 1876 sq ft

**Year built:** 2024

---

## Schools

**School District:** Tea Area

**Elementary:** Frontier Elementary School - Tea

**Middle:** Tea MS

**High School:** Tea HS

---

## Agent

**AgentEmail:** senta@justinpfeiffer.com

**AgentLastName:** Pfeiffer

**AgentFirstName:** Senta

**AgentPhoneNumber:** 605-251-1111

---

## Building Details

**Floor covering:** Carpet, Vinyl

**Exterior material:** Hard Board, Part Brick

**Parking:** Attached

**Basement:** Full

**Roof:** Shingle Composition

---

## Amenities & Features

**Features:** Master Bath, Master Bed Main Level



---

# Realty Office

**Office Name:** Hegg, REALTORS

**Office State:** SD

**Office Email:** [tina@hegg.com](mailto:tina@hegg.com)

**Office City:** Sioux Falls

**Office Phone:** 605-336-2100

**Office Website:** [www.hegg.com](http://www.hegg.com)

