



\$1,400,000

LENNOX, SD, 57039

<https://harr-lemme.com>

Holbeck Add - Tr1 - N 1/2 NW 1/4 - 27 - 99 -51

- 4 beds
- 3 baths
- Single Family, Two Story
- Outside City Limits, RESIDENTIAL
- Active
- 3835 sq ft

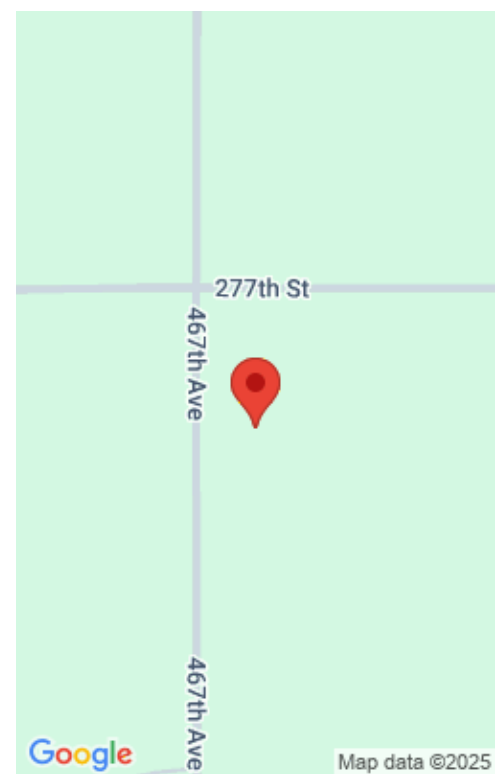

Basics

Category: Outside City Limits, RESIDENTIAL
Status: Active
Bathrooms: 3 baths
Floor level: 2329
Lot size: 435600 sq ft

Type: Single Family, Two Story
Bedrooms: 4 beds
Total rooms: 8
Area: 3835 sq ft
Year built: 2023

Schools

School District: Lennox
Middle: Lennox MS

Elementary: Lennox ES
High School: Lennox HS

Agent

AgentEmail: gdoohen@kw.com
AgentMI: T
AgentPhoneNumber: 605-728-2383

AgentFirstName: Greg
AgentLastName: Doohen

Building Details

Floor covering: Concrete, Heated, Vinyl
Exterior material: Metal, Wood
Parking: Attached

Basement: None
Roof: Metal

Amenities & Features

Features: 9 FT+ Ceiling in Lwr Lvl, Main Floor Laundry, Master Bed Main Level, Pantry, Pre-Wired High Speed, Pre-Wired Surround Sound



Realty Office

Office Name: Keller Williams Realty Sioux Falls

Office State: SD

Office Email: klrw923@kw.com

Office City: Sioux Falls

Office Phone: 605-275-0555

Office Website: siouxfalls.yourkwoffice.com/

