



\$1,390,000

27240 NOBLE CIR

<https://harr-lemme.com>

- 6 beds
- 4 baths
- Residential
- New Construction, Single Family Residence
- Active - Active
- 4280 sq ft

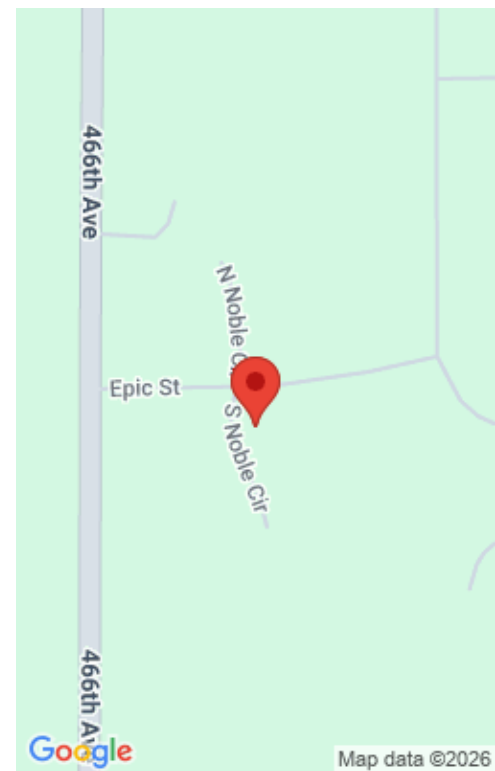

Basics

Status: Active - Active

Category: New Construction, Single Family Residence

Date added: Added 4 months ago

Bathrooms: 4 baths

Total rooms: 10

Year built: 2025

Days On Market: 132

Type: Residential

Sale Or Rent: S

Bedrooms: 6 beds

Half baths: 1 half bath

Area, sq ft: 4280 sq ft

MLS ID: 22600996

Schools

School District: Lennox

Middle: Lennox MS

High School District: Lennox

Elementary: Lennox ES

High School: Lennox HS

Middle Or Junior School District: Lennox

Agent

AgentEmail: eddie@hegg.com

AgentMI: D

AgentFirstName: Eddie

AgentLastName: Ehlers

Building Details



Parking Features: , Concrete

Parking: 8

Construction Materials: Hard Board, Stone, Metal

Heating: Natural Gas, Two or More Units, Zoned

Parcel Number: 100.50.73.E306

Basement: None

Sewer: Septic Tank

Subdivision Name: Peters First Addn to Tea

Architectural Style: Shouse

Association Fee: 100

Foundation Details: Poured, Slab

Water Source: Rural Water

Floor covering: Carpet, Heated, Tile

Roof: Metal

Lot Features: Other

Amenities & Features

Cooling: Central Air

Fireplace Features: Electric, Gas

Fireplaces Total: 2

Patio And Porch Features: , Covered Patio

