



\$1,390,000

27240 NOBLE CIR

<https://harr-lemme.com>

- 6 beds
- 3 baths
- Residential
- New Construction, Single Family Residence
- Active - Active
- 4280 sq ft

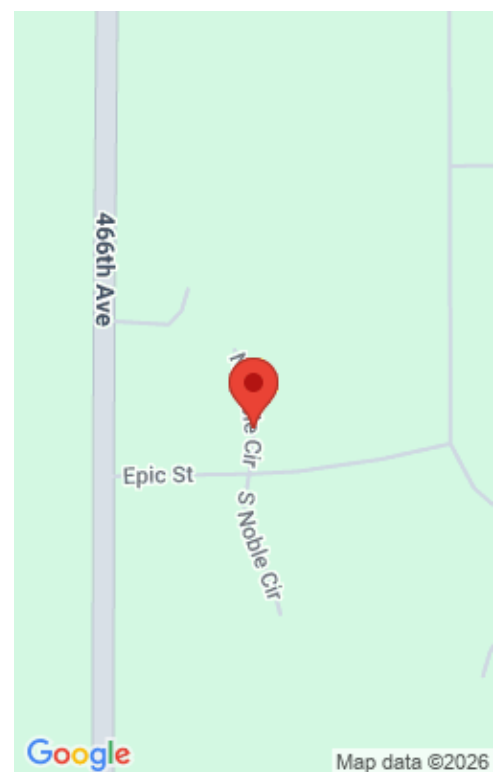

Basics

Status: Active - Active	Type: Residential
Category: New Construction, Single Family Residence	Sale Or Rent: S
Date added: Added 3 months ago	Bedrooms: 6 beds
Bathrooms: 3 baths	Half baths: 1 half bath
Total rooms: 10	Area, sq ft: 4280 sq ft
Year built: 2025	MLS ID: 22507248
Days On Market: 102	

Schools

School District: Lennox	Elementary: Lennox ES
Middle: Lennox MS	High School: Lennox HS
High School District: Lennox	Middle Or Junior School District: Lennox

Agent

AgentEmail: eddie@hegg.com	AgentFirstName: Eddie
AgentMI: D	AgentLastName: Ehlers

Building Details



Parking Features: Concrete

Parking: 8

Construction Materials: Brick, Hard Board, Metal

Heating: Natural Gas

Parcel Number: 100.50.73.E306

Basement: None

Sewer: Septic Tank

Subdivision Name: Peters First Addn to Tea

Architectural Style: Shouse

Association Fee: 100

Foundation Details: Slab

Water Source: Rural Water

Floor covering: Carpet, Laminate, Tile

Roof: Metal

Lot Features: Other

Amenities & Features

Cooling: Central Air

Fireplace Features: Gas

Fireplaces Total: 1

Patio And Porch Features: Covered Patio

