



\$575,000

26211 485TH AVE

<https://harr-lemme.com>

- 4 beds
- 3 baths
- Residential
- Outside City Limits, Single Family Residence
- Active - Active
- 2780 sq ft

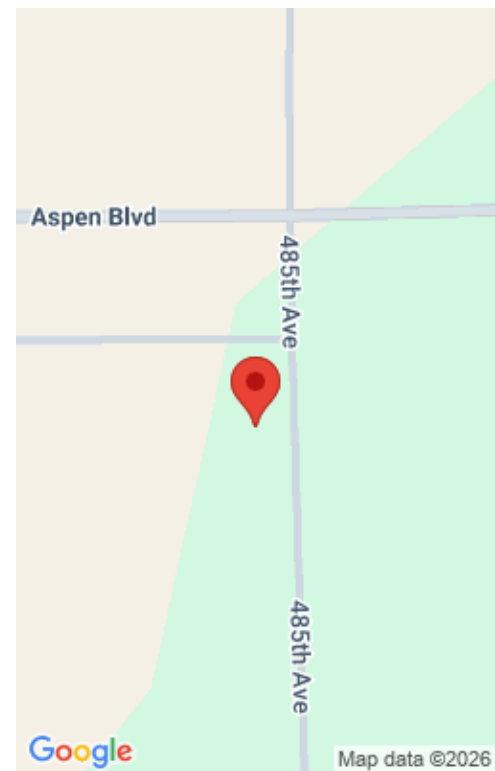

Basics

Status: Active - Active

Category: Outside City Limits, Single Family Residence

Date added: Added 2 weeks ago

Bathrooms: 3 baths

Total rooms: 12

Year built: 1955

Days On Market: 6

Type: Residential

Sale Or Rent: S

Bedrooms: 4 beds

Half baths: 1 half bath

Area, sq ft: 2780 sq ft

MLS ID: 22604262

Schools

School District: Brandon Valley 49-2

Middle: Brandon Valley MS

High School District: BrandonVal

Elementary: Valley Springs ES

High School: Brandon Valley HS

Middle Or Junior School District: BrandonVal

Agent

AgentEmail: alyssakissellrealestate@gmail.com

AgentMI: M

AgentFirstName: Alyssa

AgentLastName: Kissell

Building Details

Parking Features: , Gravel

Parking: 2

Foundation Details: Block

Water Source: Rural Water

Floor covering: Carpet, Tile, Vinyl

Roof: Composition

Lot Features: Walk-Out

Architectural Style: Ranch

Construction Materials: Concrete Block

Heating: Propane

Parcel Number: 10030

Basement: Full

Sewer: Septic Tank

Subdivision Name: Valley Springs Township



Amenities & Features

Fireplaces Total: 1

Fireplace Features: Gas

Patio And Porch Features: , Deck, Patio

