

\$36,000 ALLOWANCE TOWARDS RATE BUYDOWN WITH ACCEPTABLE OFFER



\$1,200,000

BRANDON, SD, 57005

<https://harr-lemme.com>

LOT 8 ROVANG'S SECOND ADDN SE1/4 & S1/2 NE1/4 21-102-48

- 5 beds
- 4 baths
- Shouse, Single Family
- Outside City Limits, RESIDENTIAL
- Active
- 3460 sq ft

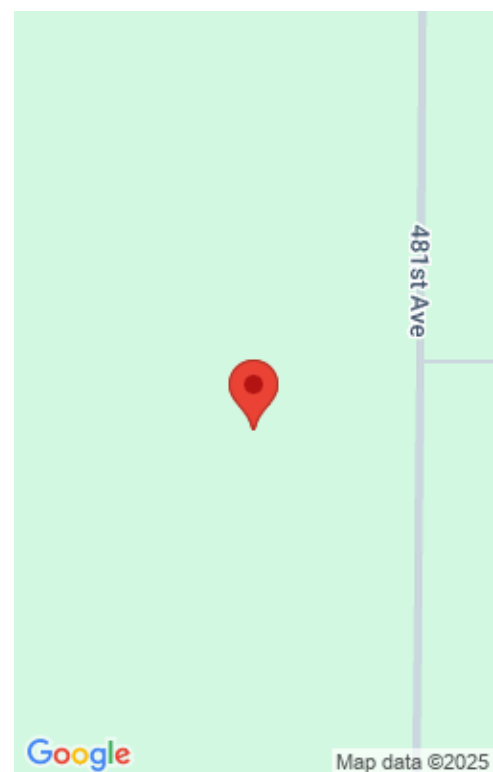

Basics

Category: Outside City Limits, RESIDENTIAL
Status: Active
Bathrooms: 4 baths
Floor level: 3460
Lot size: 304920 sq ft

Type: Shouse, Single Family
Bedrooms: 5 beds
Total rooms: 11
Area: 3460 sq ft
Year built: 2021

Schools

School District: Brandon Valley 49-2
Middle: Brandon Valley MS

Elementary: Brandon ES
High School: Brandon Valley HS

Agent

AgentEmail: mackenzie@amystockberger.com
AgentMI: L
AgentPhoneNumber: 605-988-7520

AgentFirstName: Mackenzie
AgentLastName: Hanssen

Building Details

Floor covering: Carpet, Ceramic, Heated, Luxury Vinyl Plank
Exterior material: Metal, Wood
Parking: Attached

Basement: None
Roof: Metal

Amenities & Features

Features: 3+ Bedrooms Same Level, Main Floor Laundry, Master Bath, Master Bed Main Level, Pantry, Pre-Wired Surround Sound, Tray Ceiling, Vaulted Ceiling



Realty Office

Office Name: Amy Stockberger Real Estate

Office State: SD

Office Email: adam@asteaminc.com

Office City: Sioux Falls

Office Phone: 605-376-6780

Office Website: amystockberger.com

