



\$525,000

SIOUX FALLS, SD, 57104

<https://harr-lemme.com>

TRACT 2 EGGER'S ADDITION SW 1/4 NW 1/4 11 102 49 MAPLETON
TOWNSHIP 102-49

- 4 beds
- 2 baths
- Multi Level, Single Family
- Outside City Limits, RESIDENTIAL
- Active
- 2404 sq ft

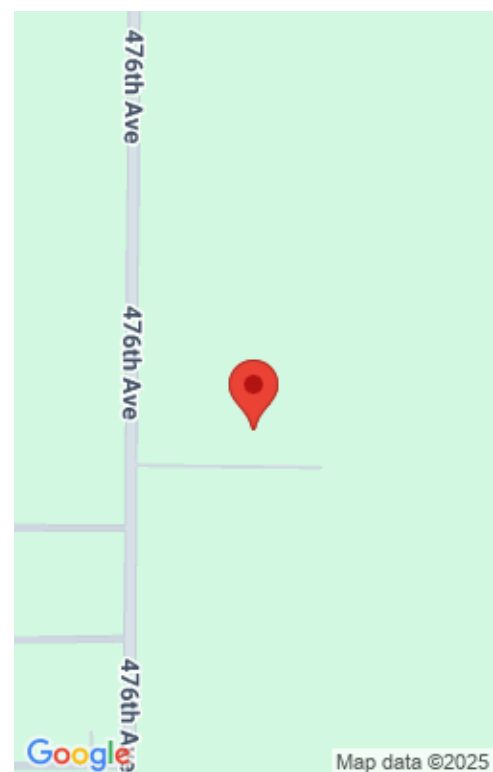

Basics

Category: Outside City Limits, RESIDENTIAL

Status: Active

Bathrooms: 2 baths

Floor level: 750

Lot size: 43560 sq ft

Type: Multi Level, Single Family

Bedrooms: 4 beds

Total rooms: 10

Area: 2404 sq ft

Year built: 1994

Schools

School District: Brandon Valley 49-2

Middle: Brandon Valley MS

Elementary: Brandon ES

High School: Brandon Valley HS

Agent

AgentEmail: jack@thinkalpine.com

AgentMI: M

AgentPhoneNumber: 605-940-1578

AgentFirstName: Jack

AgentLastName: VanLeur

Building Details

Floor covering: Carpet, Luxury Vinyl Plank

Exterior material: Hard Board, Stone/Stone Veneer

Parking: Attached

Basement: Full

Roof: Shingle Composition

Realty Office



Office Name: Alpine Residential
Office State: SD
Office Email: residential@thinkalpine.com

Office City: Sioux Falls
Office Phone: 605-607-7355
Office Website: thinkalpine.com

