



**\$749,900.00**

## **25394 472ND AVE**

<https://harr-lemme.com>

**TRACT 2 OLSON'S ADDITION SW1/4 SW1/4 19 103 49 SVERDRUP  
TOWNSHIP**

- 3 beds
- 2 baths
- Ranch, Shouse, Single Family
- Outside City Limits, RESIDENTIAL
- Active, Active-New
- 1900 sq ft

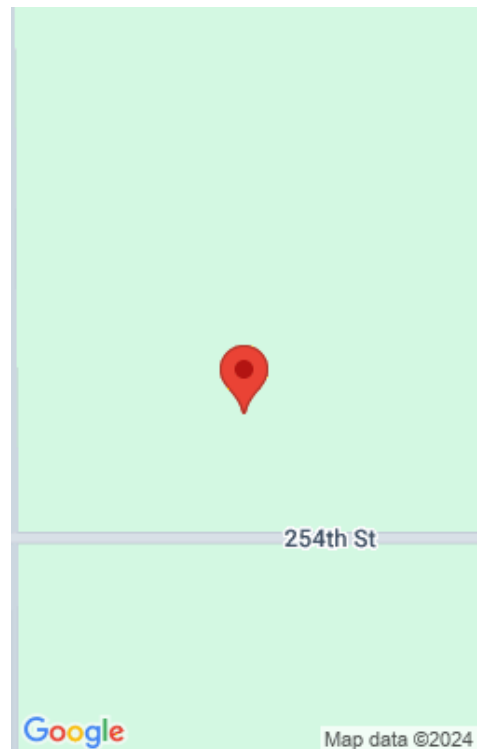

---

## Basics

**Category:** Outside City Limits, RESIDENTIAL

**Status:** Active, Active-New

**Bathrooms:** 2 baths

**Floor level:** 1900

**Lot size:** 174240 sq ft

**Type:** Ranch, Shouse, Single Family

**Bedrooms:** 3 beds

**Total rooms:** 7

**Area:** 1900 sq ft

**Year built:** 2019

---

## Schools

**School District:** Baltic 49-1

**Middle:** Baltic MS

**Elementary:** Baltic ES

**High School:** Baltic HS

---

## Agent

**AgentEmail:** sarahgross@kw.com

**AgentMI:** L

**AgentPhoneNumber:** 605-759-2982

**AgentFirstName:** Sarah

**AgentLastName:** Gross

---

## Building Details

**Floor covering:** Concrete, Heated, Vinyl

**Exterior material:** Hard Board

**Parking:** Attached

**Basement:** None

**Roof:** Metal, Shingle Composition

---

## Amenities & Features

**Features:** 3+ Bedrooms Same Level, Formal Dining Rm, Main Floor Laundry, Master Bed Main Level, Pantry



---

# Realty Office

**Office Name:** Keller Williams Realty Sioux Falls

**Office State:** SD

**Office Email:** [klrw923@kw.com](mailto:klrw923@kw.com)

**Office City:** Sioux Falls

**Office Phone:** 605-275-0555

**Office Website:** [siouxfalls.yourkwoffice.com/](http://siouxfalls.yourkwoffice.com/)

