



\$725,000

25115 466TH AVE

<https://harr-lemme.com>

- 5 beds
- 3 baths
- Residential
- Outside City Limits, Single Family Residence
- Active - Active
- 3390 sq ft

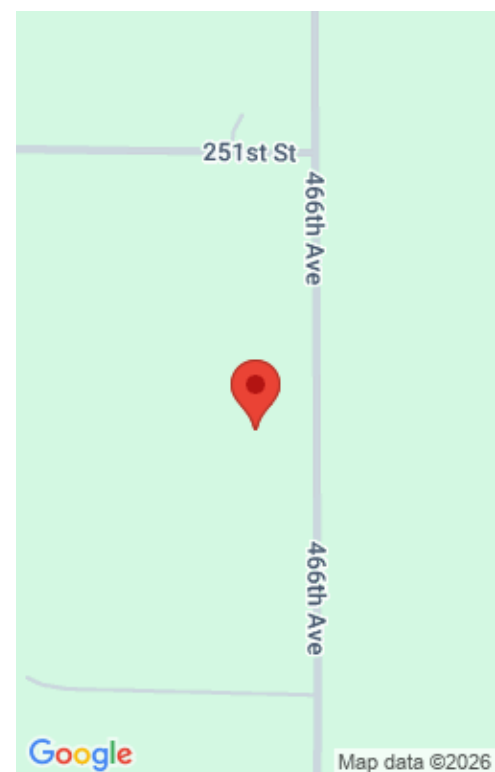

Basics

Status: Active - Active

Category: Outside City Limits, Single Family Residence

Date added: Added 2 days ago

Bathrooms: 3 baths

Total rooms: 9

Year built: 1997

Days On Market: 1

Type: Residential

Sale Or Rent: S

Bedrooms: 5 beds

Half baths: 0 half baths

Area, sq ft: 3390 sq ft

MLS ID: 22600153

Schools

School District: Tri-Valley

Middle: Tri-Valley JHS

High School District: TriValley

Elementary: Tri-Valley ES

High School: Tri-Valley HS

Middle Or Junior School District: TriValley

Agent

AgentEmail: Matthewfisher@kw.com

AgentMI: D

AgentFirstName: Matthew

AgentLastName: Fisher

Building Details

Architectural Style: Ranch

Construction Materials: Hard Board

Heating: Natural Gas, 90% Efficient

Parcel Number: 17899

Basement: Full

Lot Features: Other

Parking: 2

Foundation Details: Poured

Water Source: Rural Water

Floor covering: Carpet, Vinyl

Roof: Composition

Subdivision Name: Arends Addn 12-103-51





Amenities & Features

Cooling: Central Air

Fireplaces Total: 2

Fireplace Features: Gas

Patio And Porch Features: Deck

