



\$495,000

24253 467A AVE

<https://harr-lemme.com>

- 4 beds
- 1 bath
- Residential
- Manufactured Home, Outside City Limits
- Active - Active
- 2520 sq ft

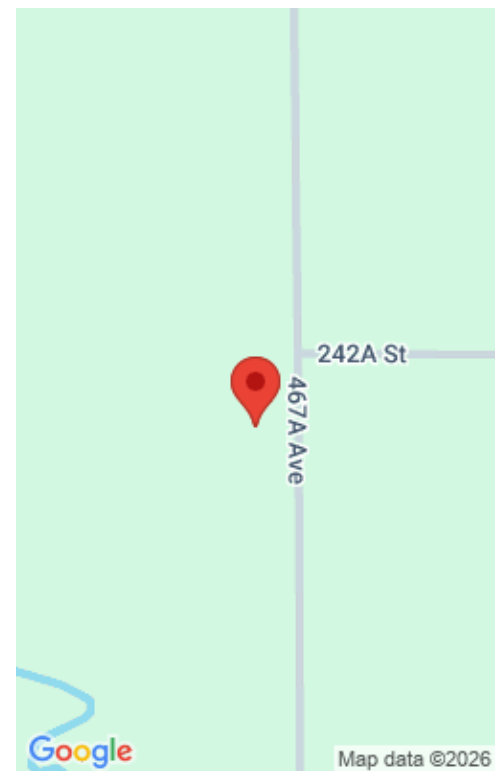

Basics

Status: Active - Active

Category: Manufactured Home, Outside City Limits

Date added: Added 2 days ago

Bathrooms: 1 bath

Total rooms: 11

Year built: 1993

Days On Market: 1

Type: Residential

Sale Or Rent: S

Bedrooms: 4 beds

Half baths: 1 half bath

Area, sq ft: 2520 sq ft

MLS ID: 22602215

Schools

School District: Chester Area 39-1

Middle: Chester JHS

High School District: ChesterAre

Elementary: Chester ES

High School: Chester HS

Middle Or Junior School District: ChesterAre

Agent

AgentEmail: tom@schwebach.com

AgentLastName: Schwebach

AgentFirstName: Tom

Building Details

Architectural Style: Ranch

Construction Materials: Hard Board

Heating: Natural Gas, Heat Pump, Propane

Parcel Number: 105.50.29.310

Basement: Full

Sewer: Septic Tank

Parking: 2

Foundation Details: Block

Water Source: Rural Water

Floor covering: Carpet, Laminate, Vinyl

Roof: Composition

Subdivision Name: No Subdivision



Amenities & Features

Cooling: Central Air

Patio And Porch Features: Deck

Pool Features: Above Ground

