

Address
1001 S FOSS AVE

City Parcel ID
012224251006000

County / County Parcel ID
MINNEHAHA / 96673

Legal
LOT 6 BLOCK 1 DAWLEY FARM VILLAGE ADDITION TO THE CITY OF SIOUX FALLS

Acres / Square Feet
0.40 / 17,429.00

Land Use Activity
93 - Developing Site - Unavailable

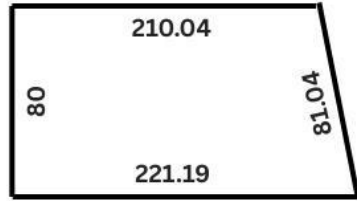

- Land
- None
- Active - Active

1001 FOSS AVE

<https://harr-lemme.com>

Basics

Status: Active - Active

Category: None

Date added: Added 3 days ago

Days On Market: 2

Type: Land

Sale Or Rent: S

MLS ID: 22604346

Schools

School District: Sioux Falls

Middle: Ben REifel Middle School

High School District: Sioux Falls

Elementary: Rosa Parks ES

High School: Washington HS

Middle Or Junior School District: Sioux Falls



Agent

AgentEmail: David.Shelton@c21adv.com

AgentMI: W

AgentFirstName: David

AgentLastName: Shelton

Building Details

Water Source: Public

Utilities: Cable Available, Natural Gas Available,
Electricity Available, Sewer Available, Phone Available

Lot Features: Interior Lot, City Lot

Parcel Number: 96673

Sewer: Public Sewer

Subdivision Name: Dawley Farm
Village

Amenities & Features

Fencing: None

